

A  $\frac{307}{226}$



ШКАФЪ 114.

ПОЛКА 1.

№ 12

А 307  
226







ms. 69

Q 13/99







Петербургъ, 30 марта 1884 г.

САНКТ-ПЕТЕРБУРГСКАЯ  
ПЕЧАТНИЦА  
В. И. Смирнова  
Воспитательной Академии  
Р. К. А. 13199

1957 г.



А 307  
226

114 I. 12

114 I. 12

ПОРТОВЫЕ

ПРОБЕЖЕНО

# ТОВАРНЫЕ СКЛАДЫ.

ЧЕРТЕЖИ.

СОСТАВИЛЪ

А. Г. НЮБЕРГЪ,

Э. о. Профессоръ Института Инженеровъ Путей Сообщенія Императора Александра I.

С.-ПЕТЕРБУРГЪ.

Типографія Министерства Путей Сообщенія (А. Бенке), Фонтанка, № 99.

1884.

Q13199

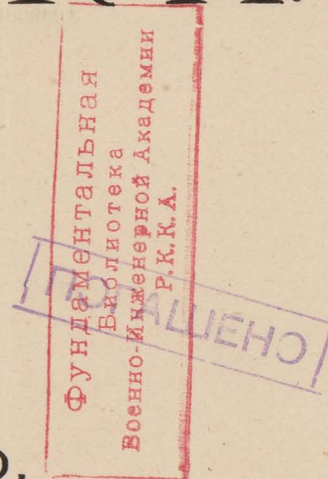



Государственная  
Библиотека  
СССР  
им. В. И. Ленина

32/0-65

Дозволено цензурою.



2011120820



















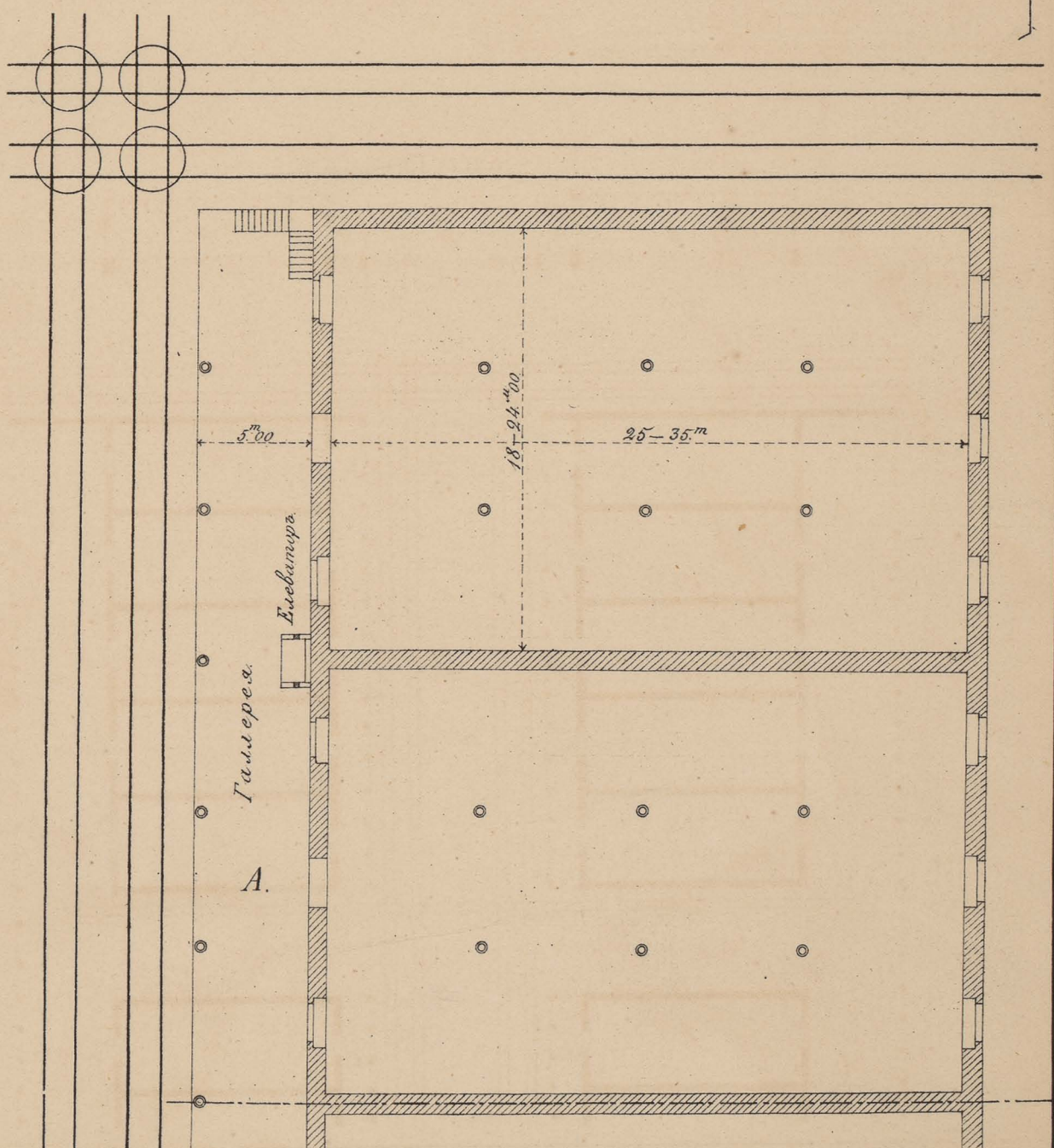
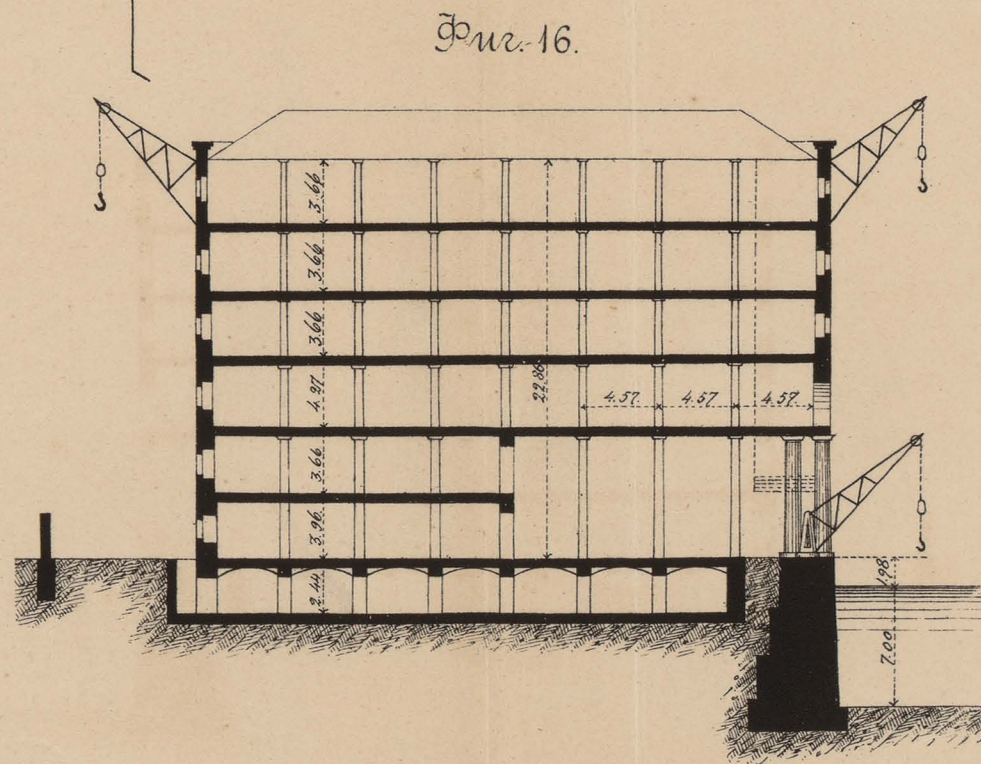
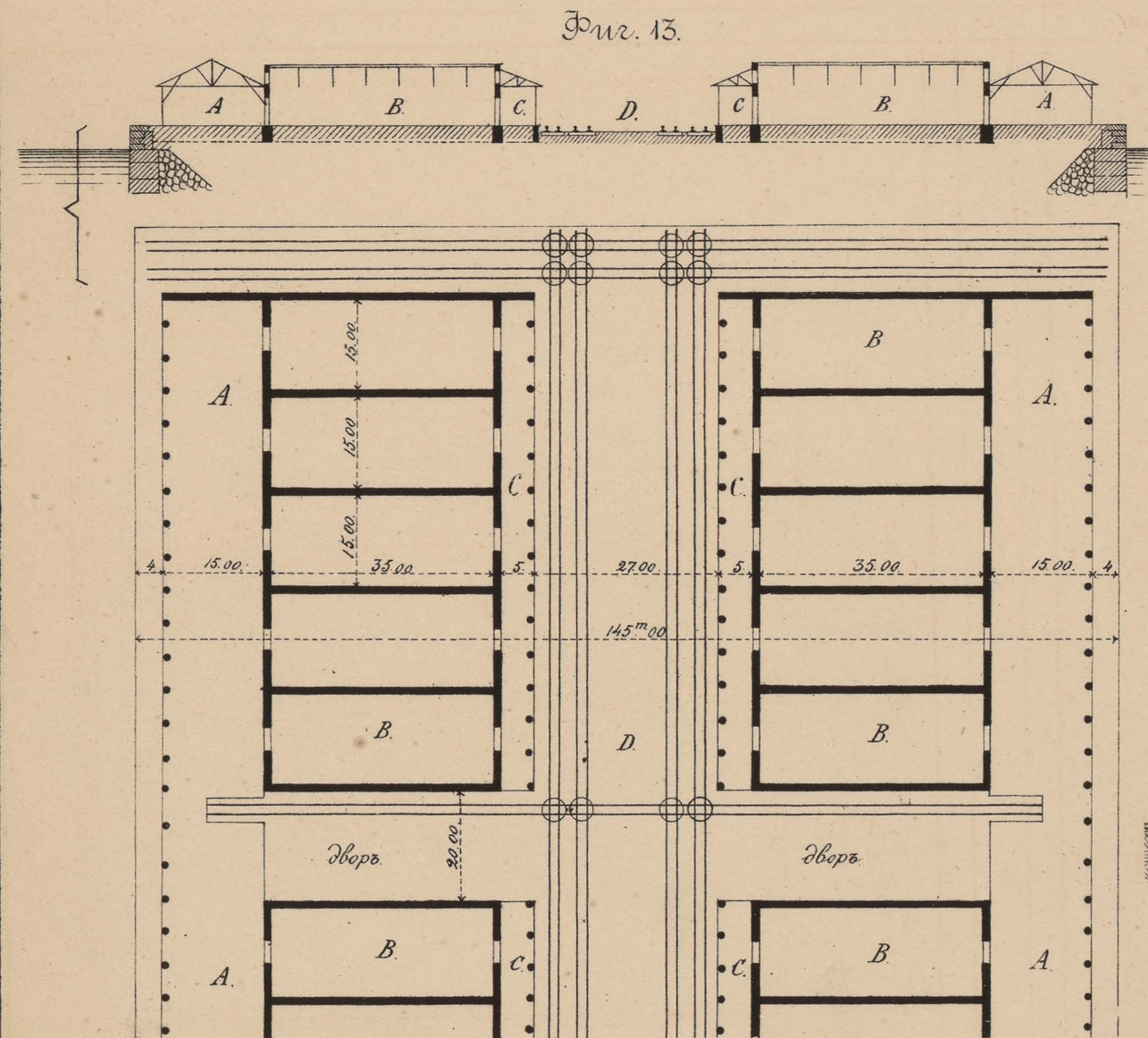
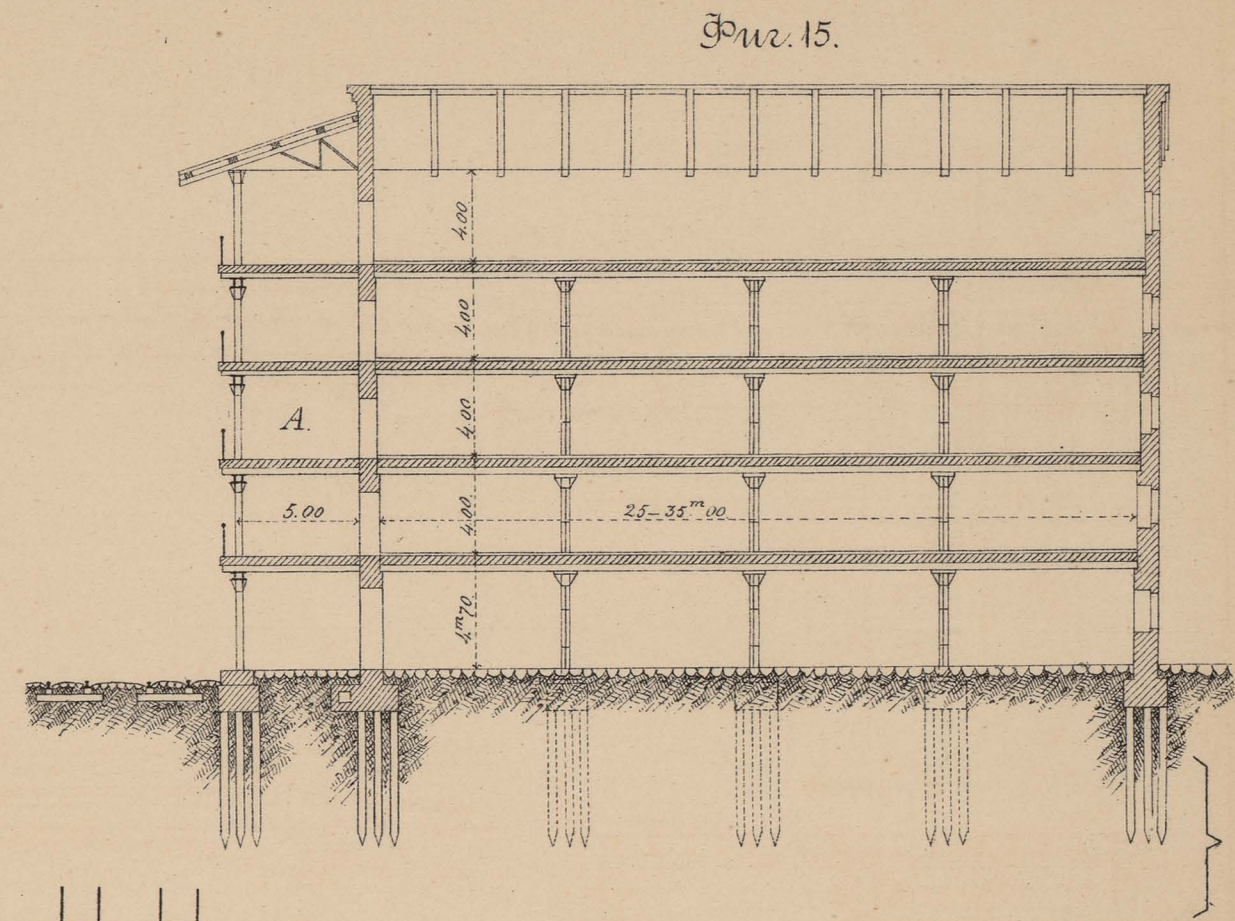
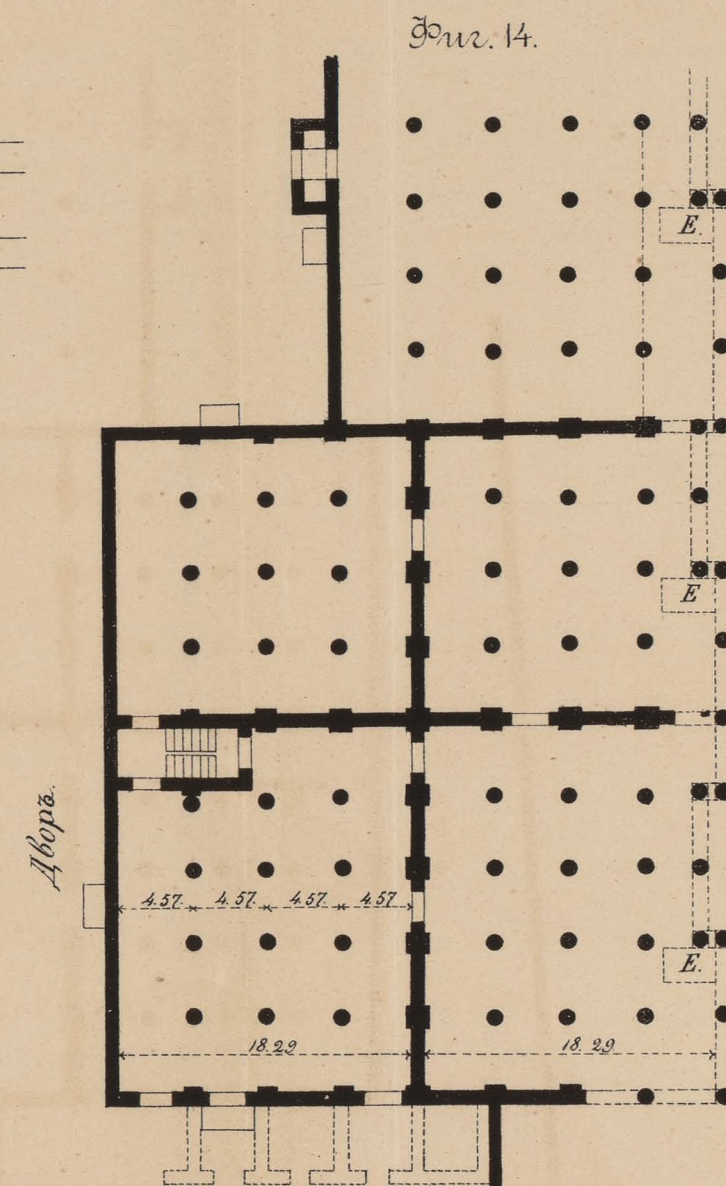
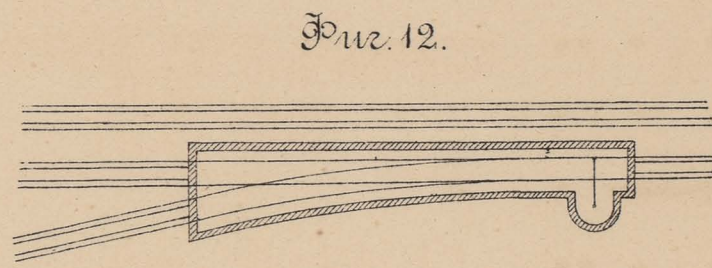
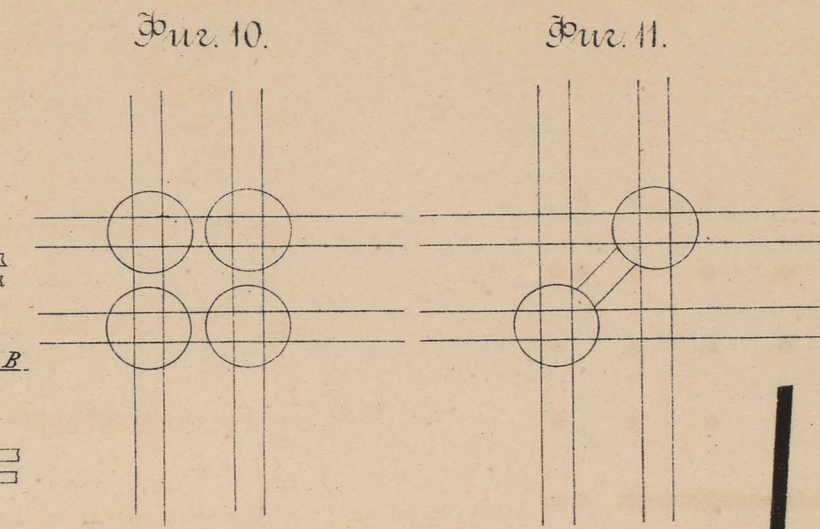
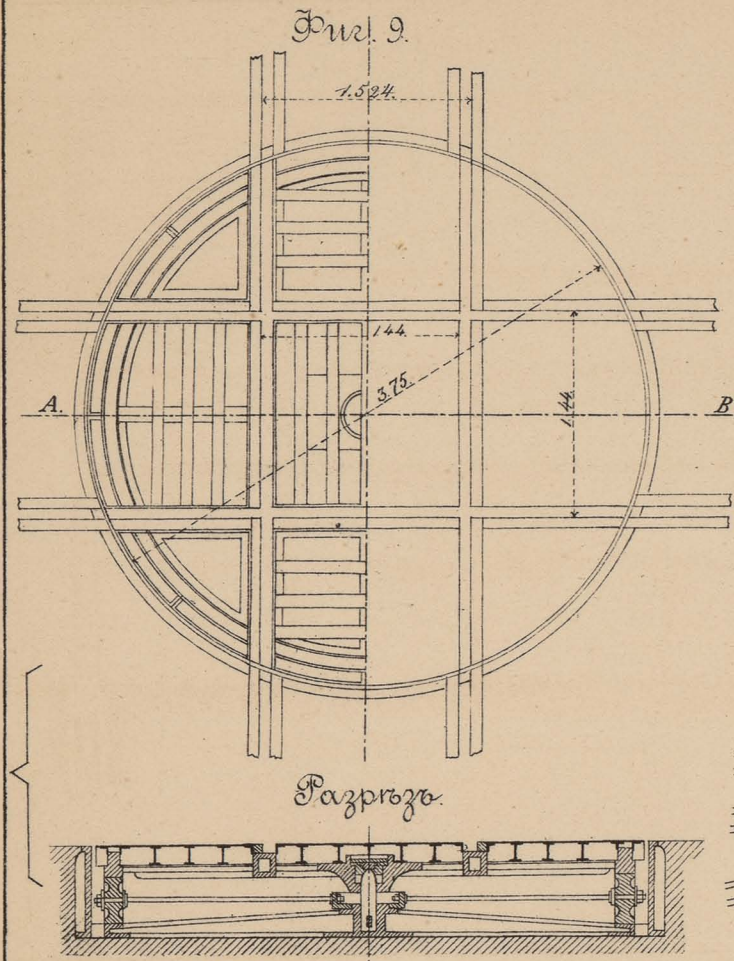











Фиг. 17.

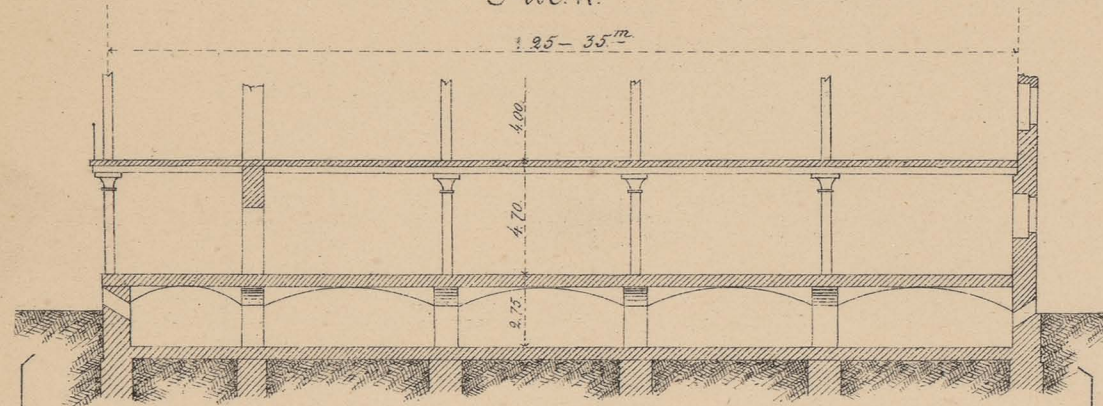

Фиг. 18.

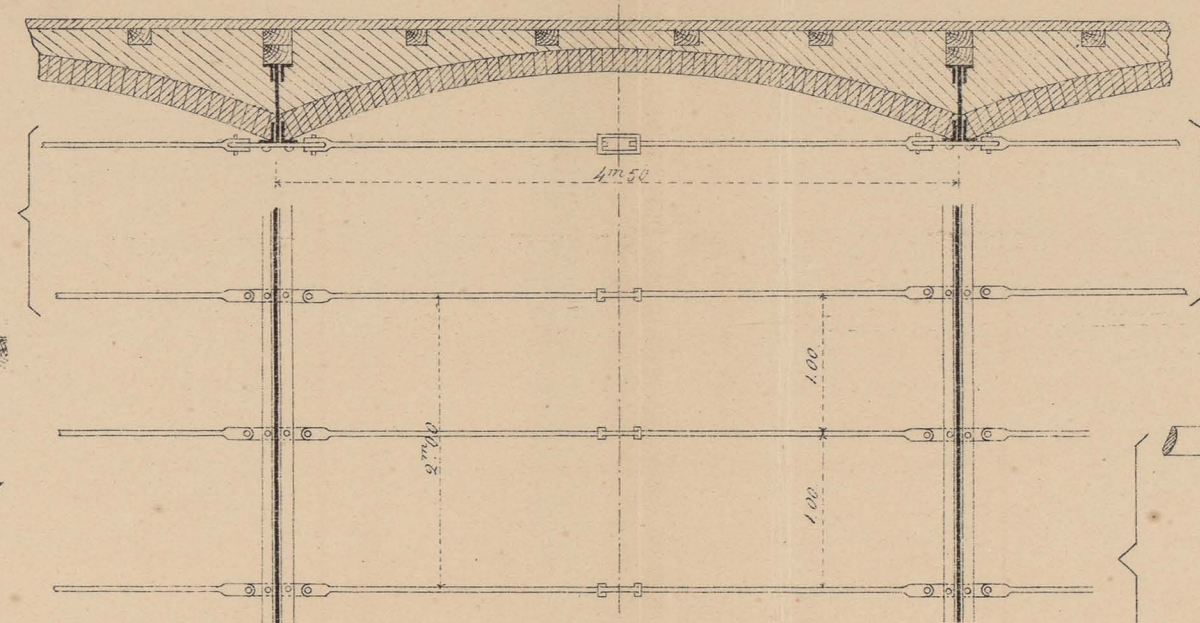

Фиг. 22.

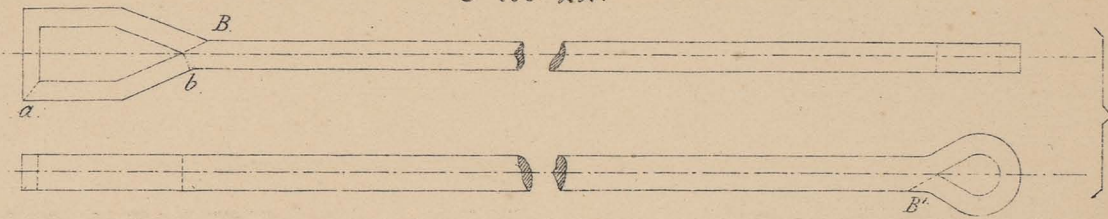

Фиг. 23.

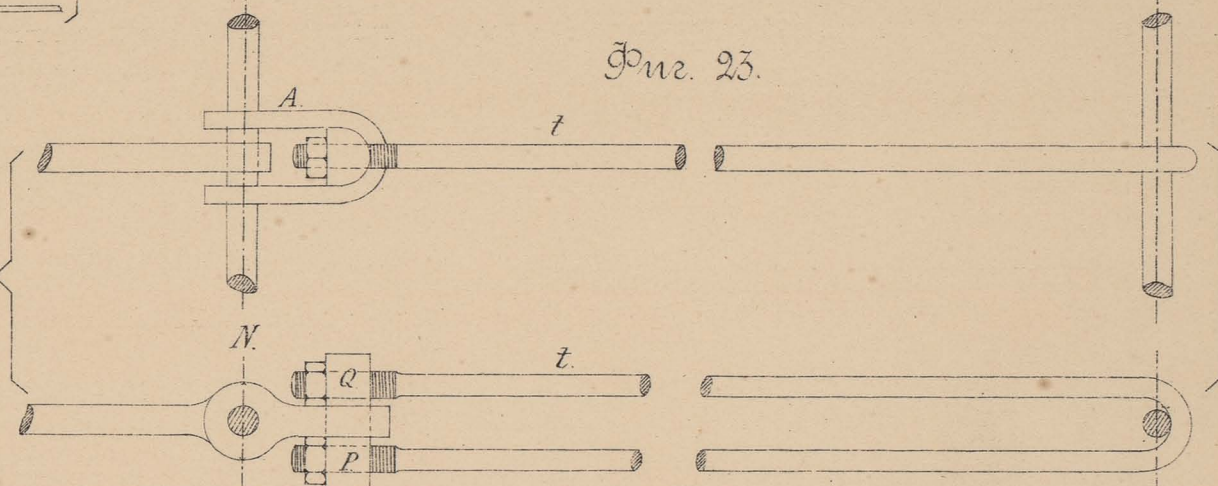

Фиг. 24.

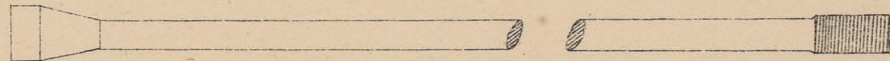

Фиг. 25.

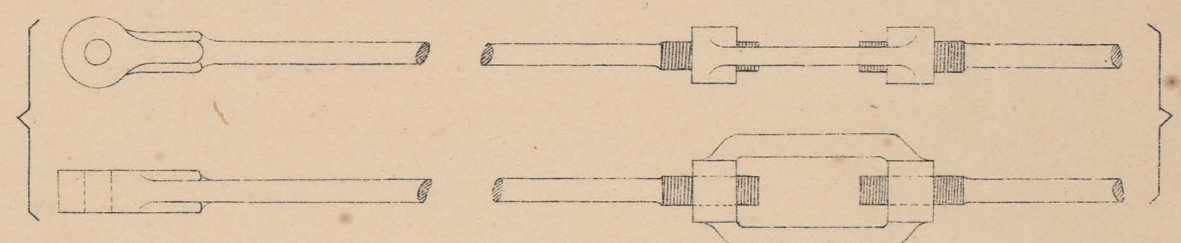

Фиг. 19.

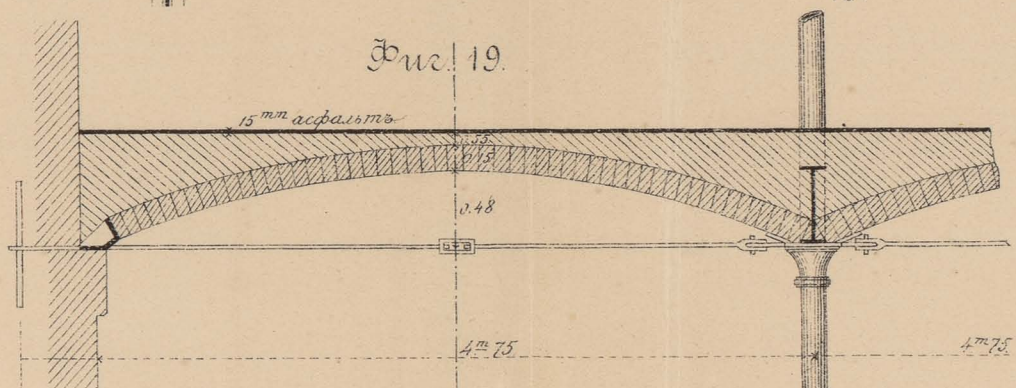

Фиг. 20.

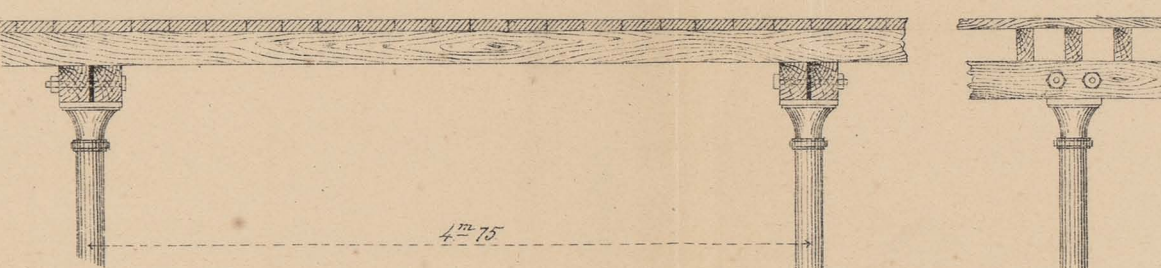

Фиг. 21.  
(а.)

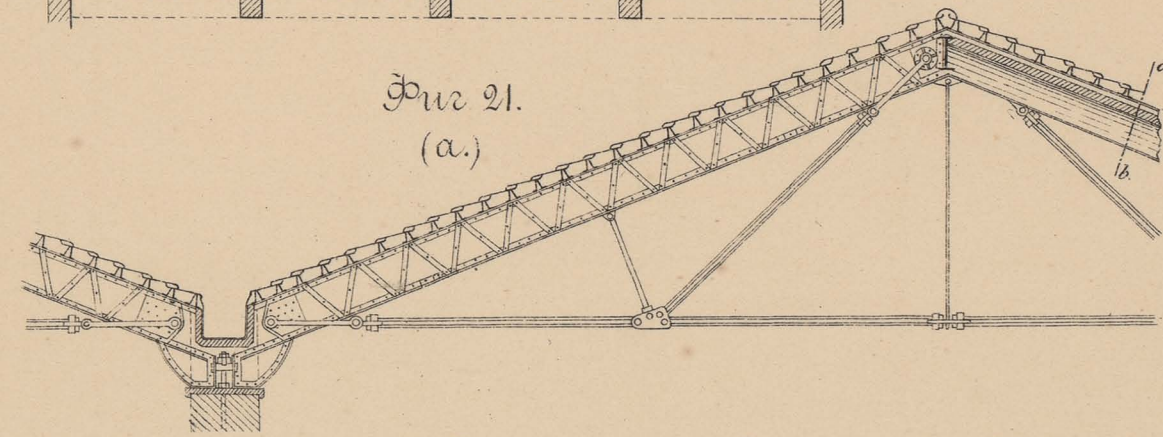

Разрѣзъ по а-в, Фиг. 21. (б.)

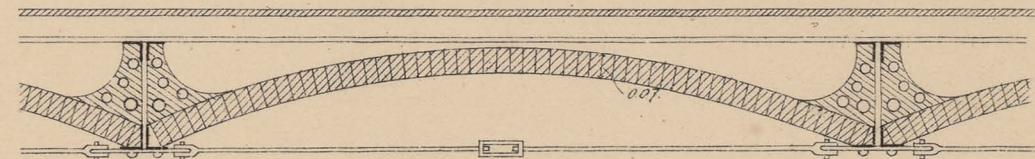

Деталь къ фиг. 21.  
(с.)

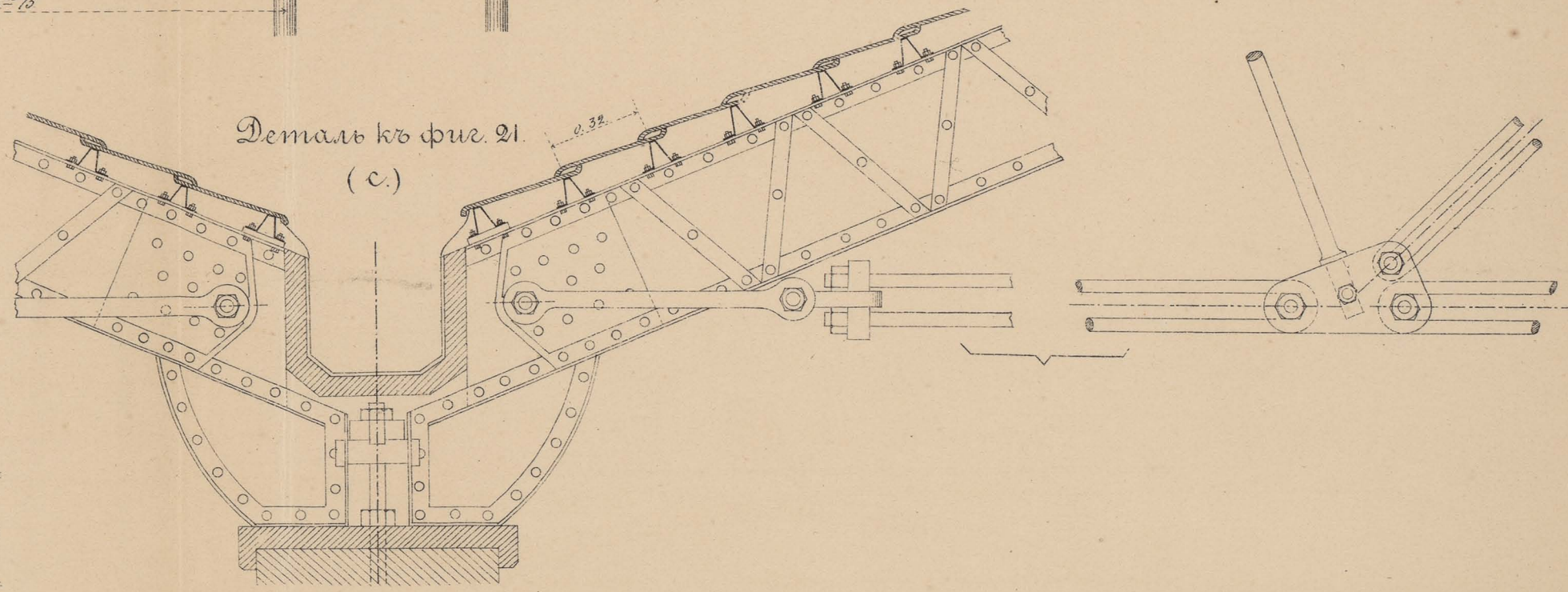











Фиг. 26.

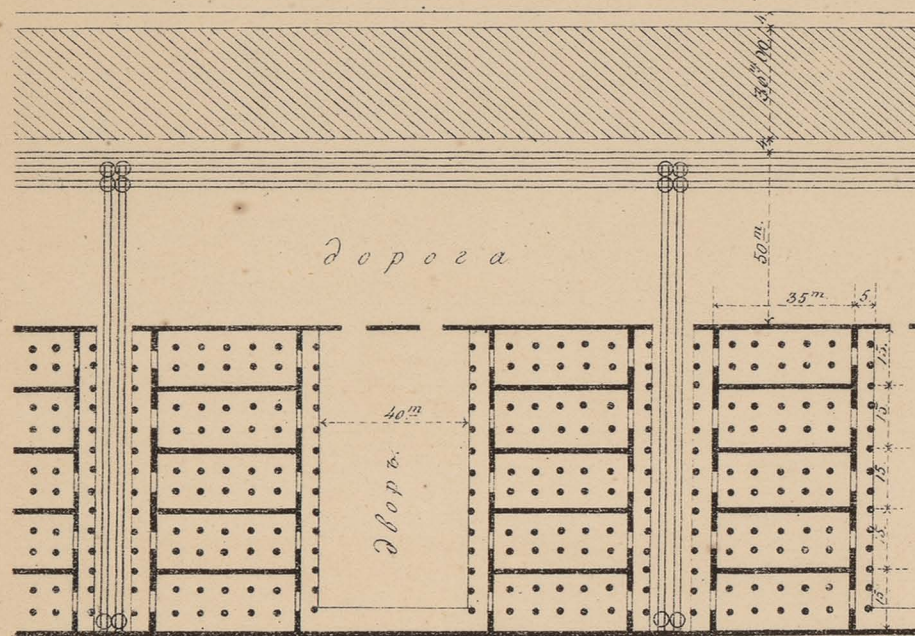

Фиг. 27.

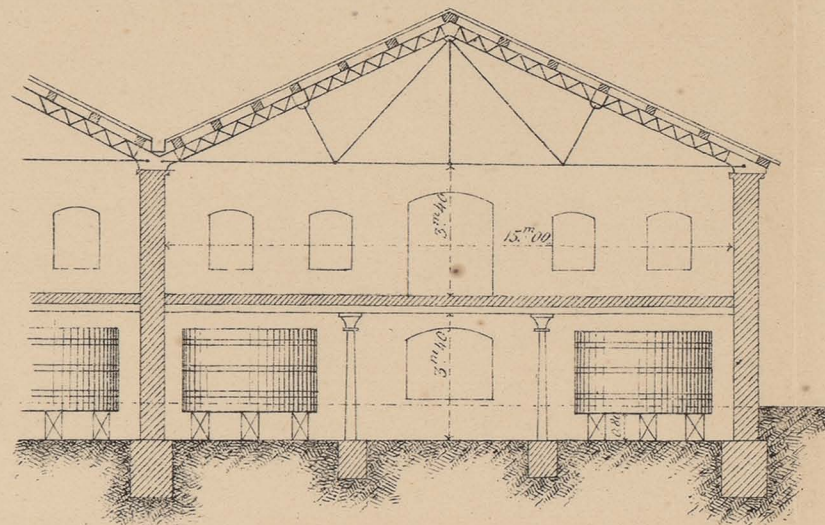

Фиг. 28.

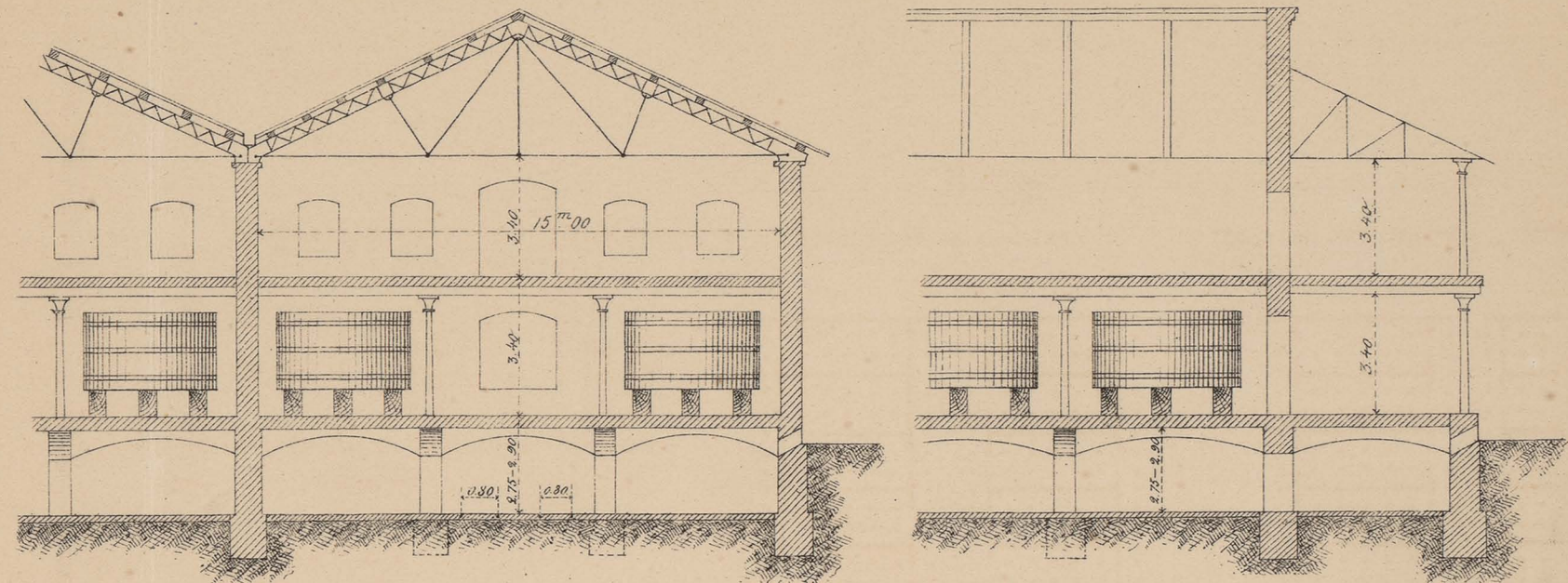

Фиг. 29.

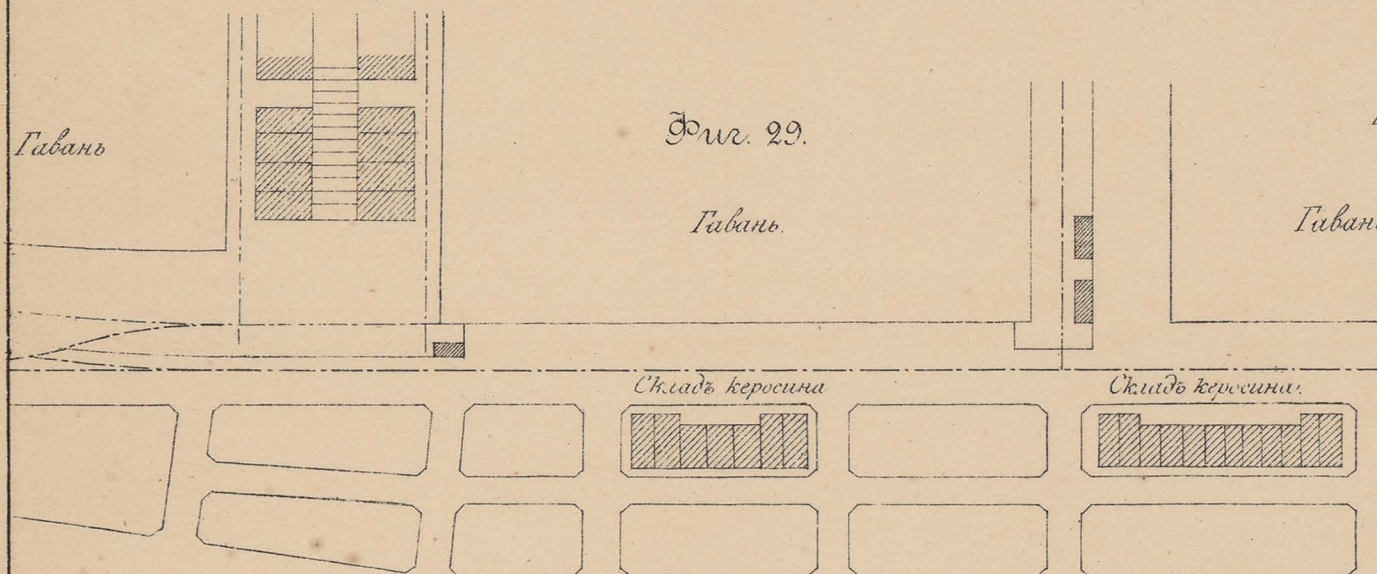

Вагонъ Цистерна.

Гавань

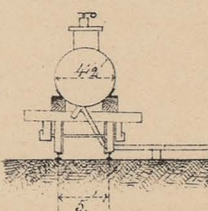

Сливной резервуаръ

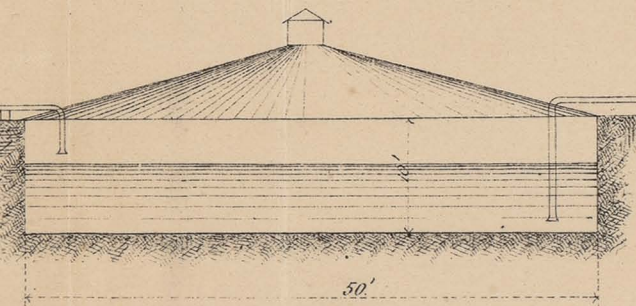

Фиг. 31.

Насосъ

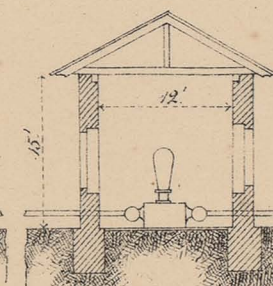

Главный резервуаръ для склада.

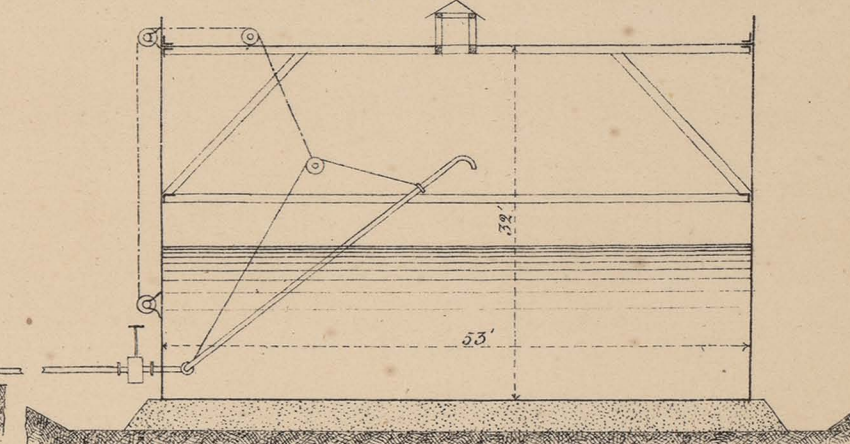

Фиг. 30.

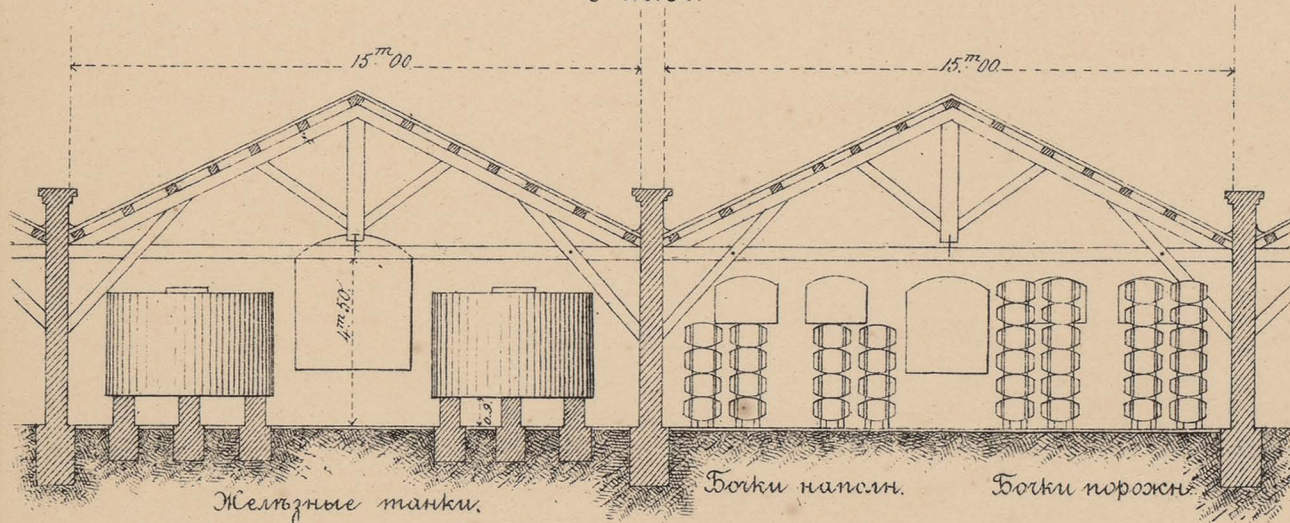

Фиг. 32.

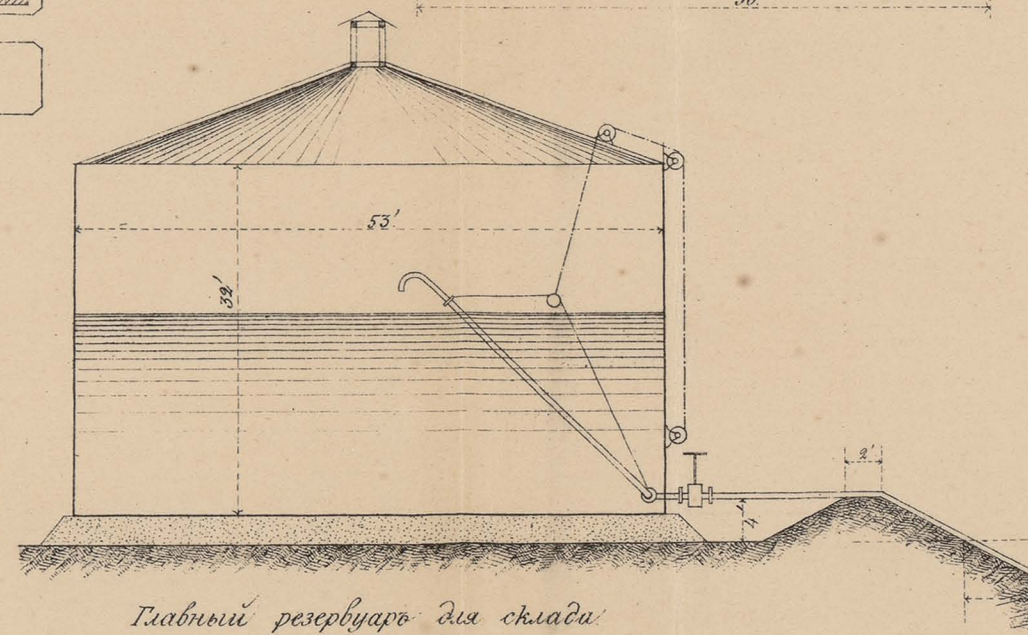

Главный резервуаръ для склада

Насосъ

Керосиновая баржа.

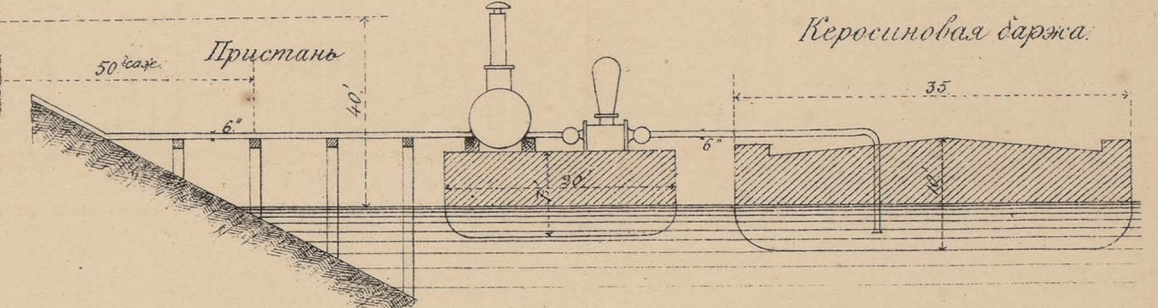











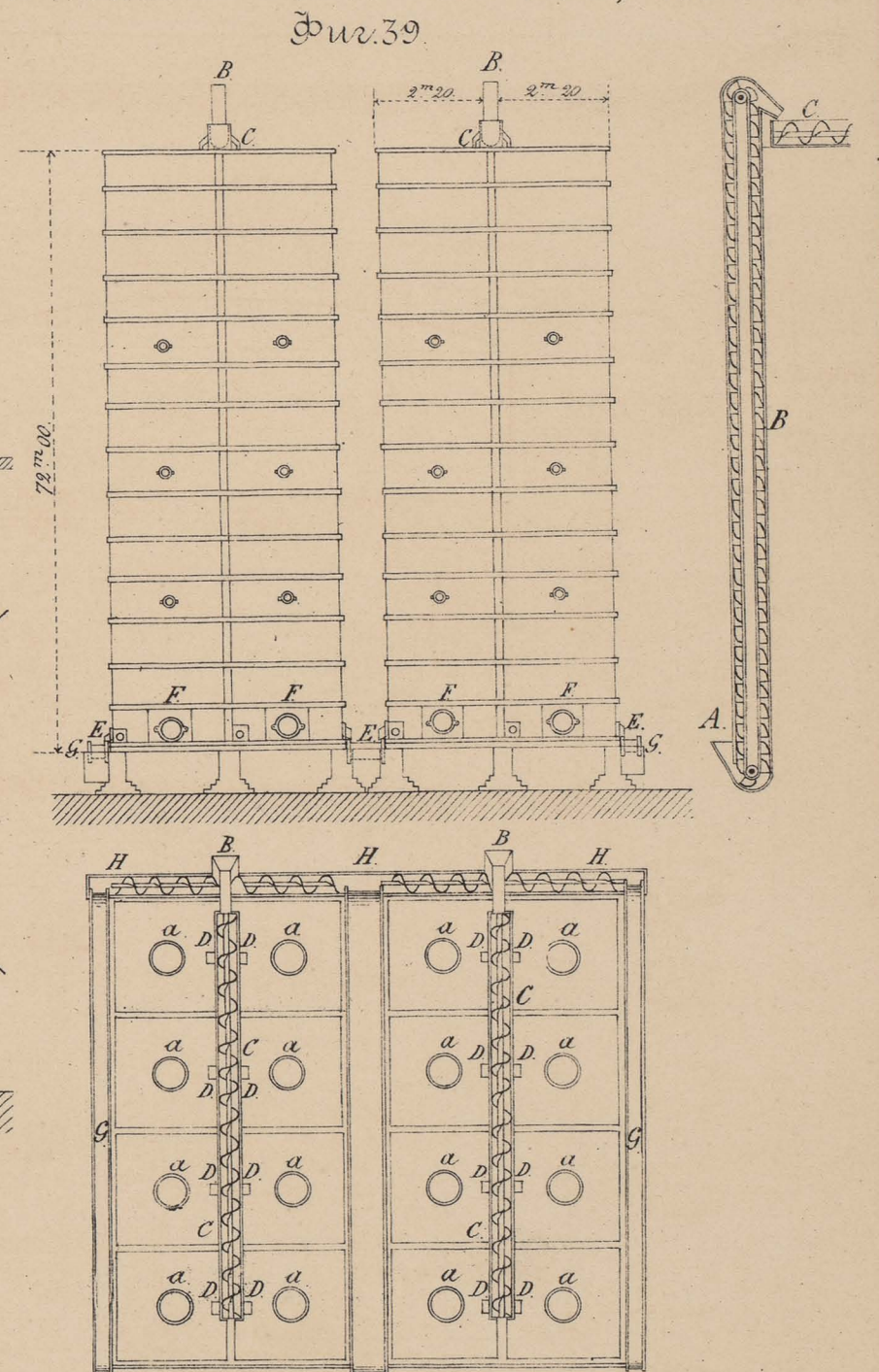
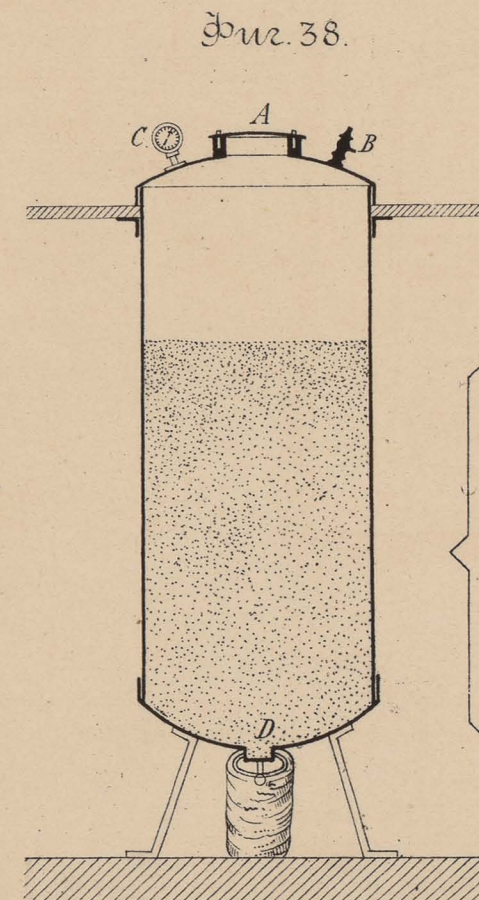
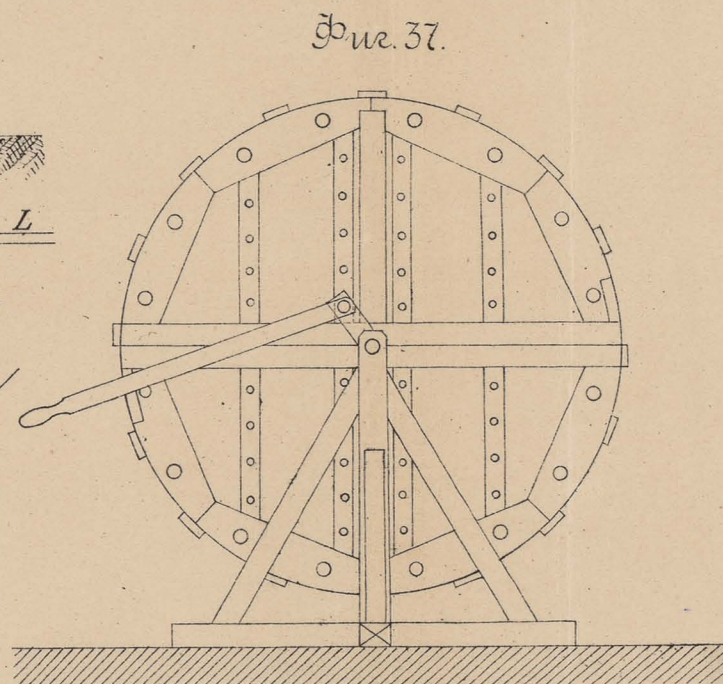
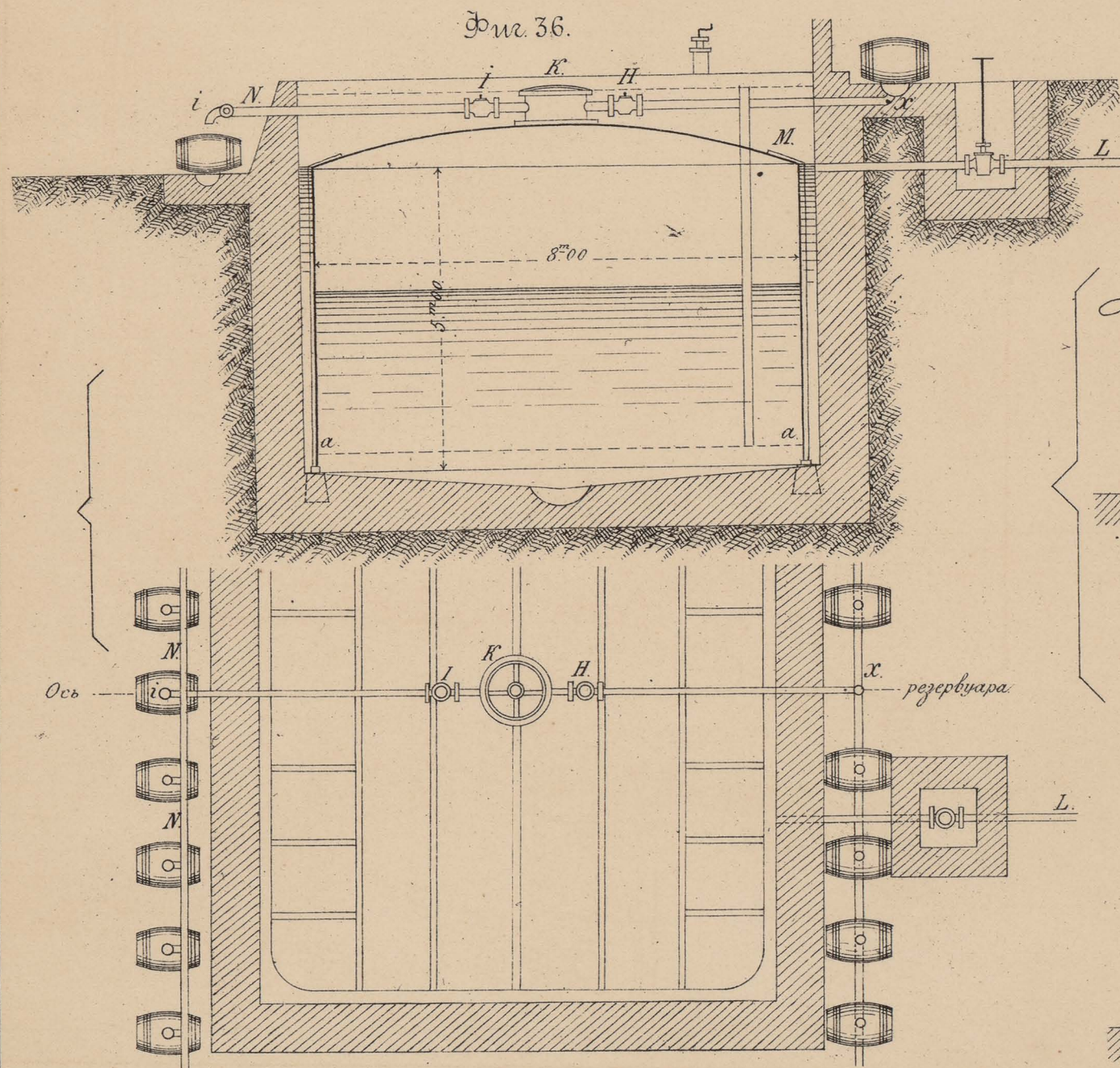
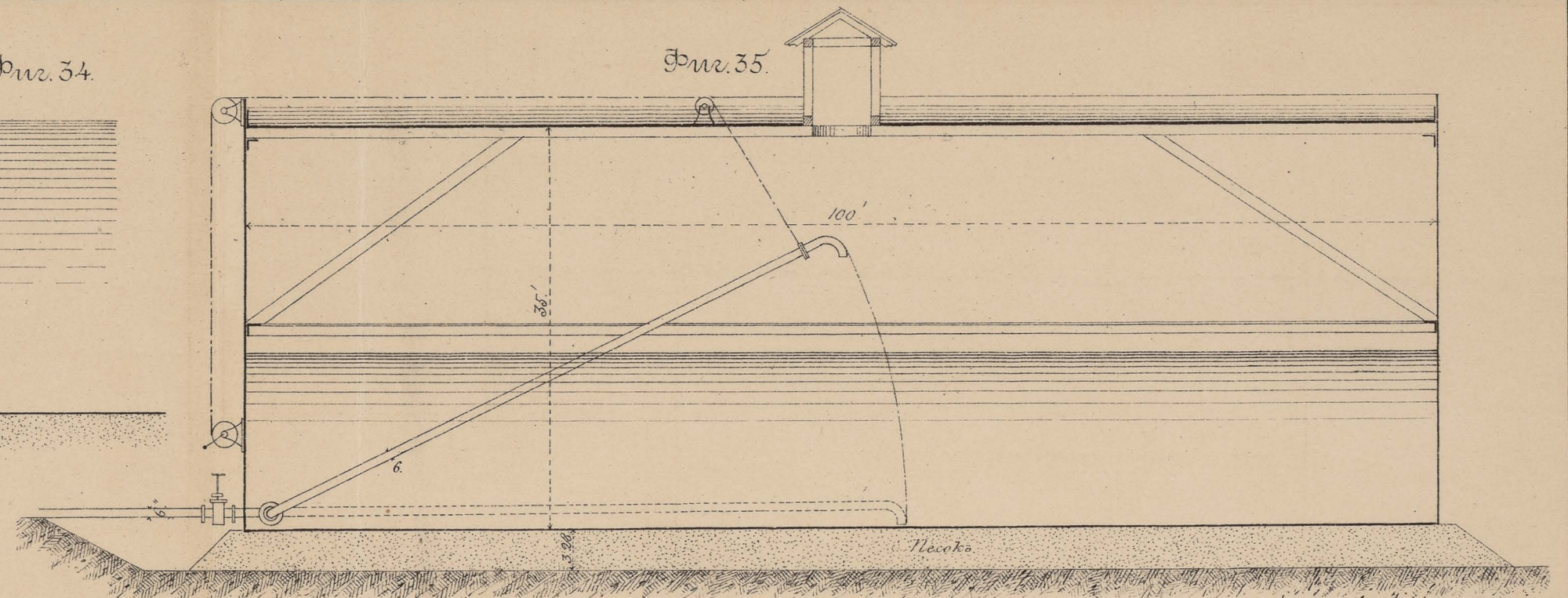
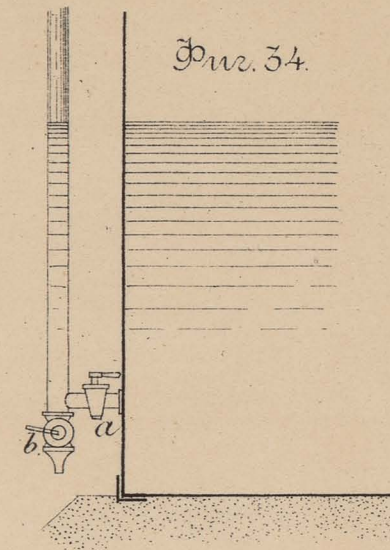
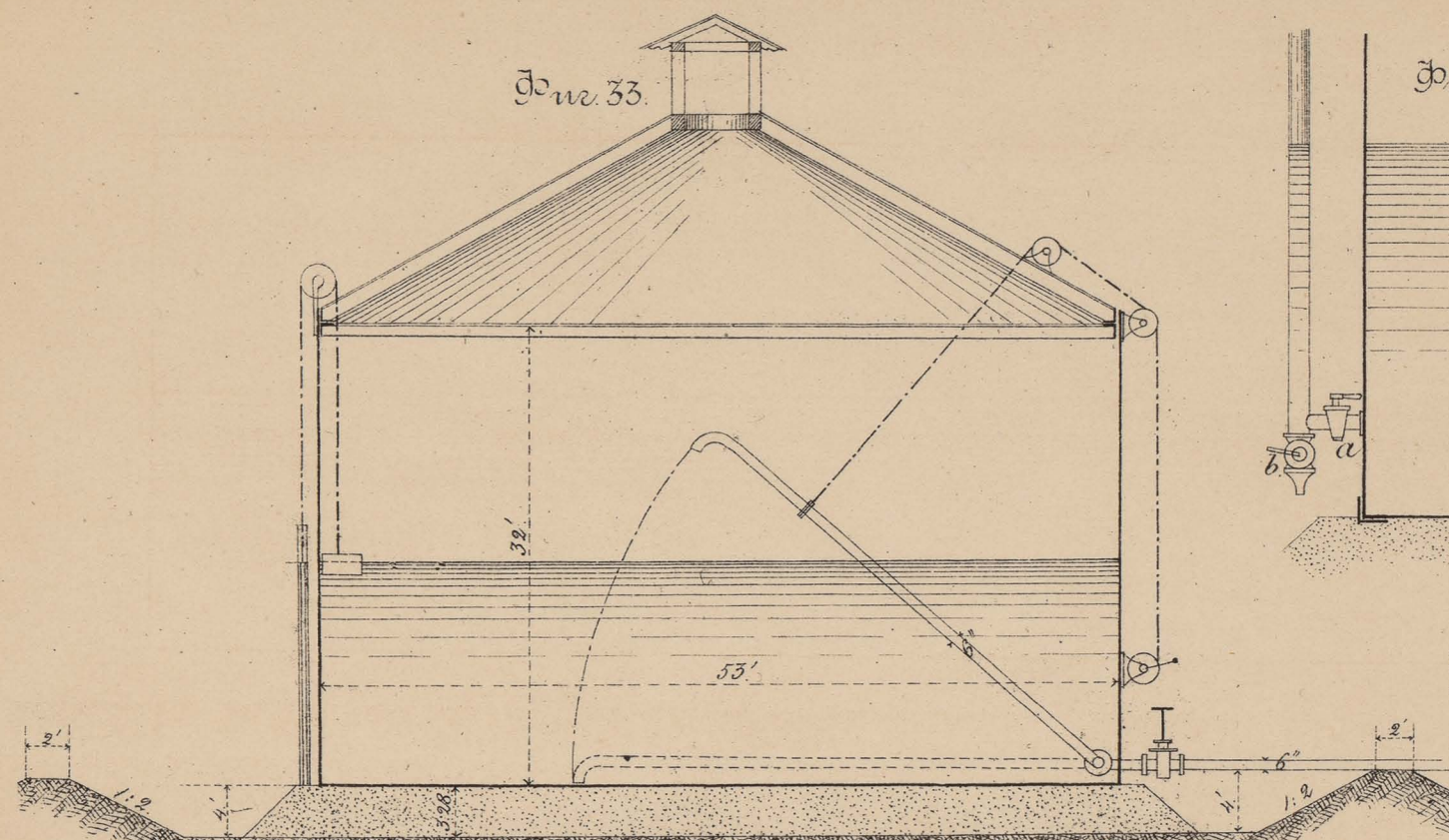











Фиг. 40.

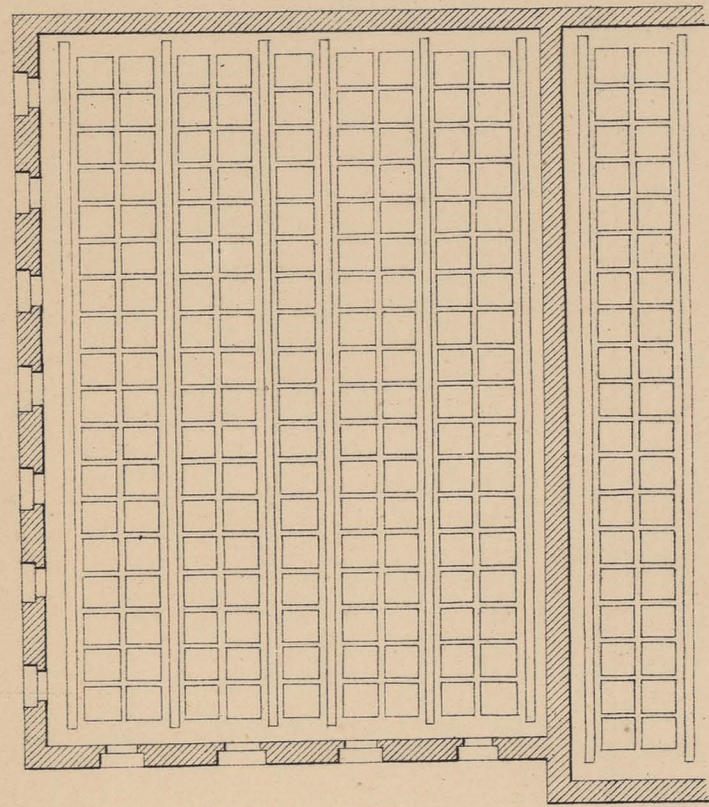

Фиг. 41.

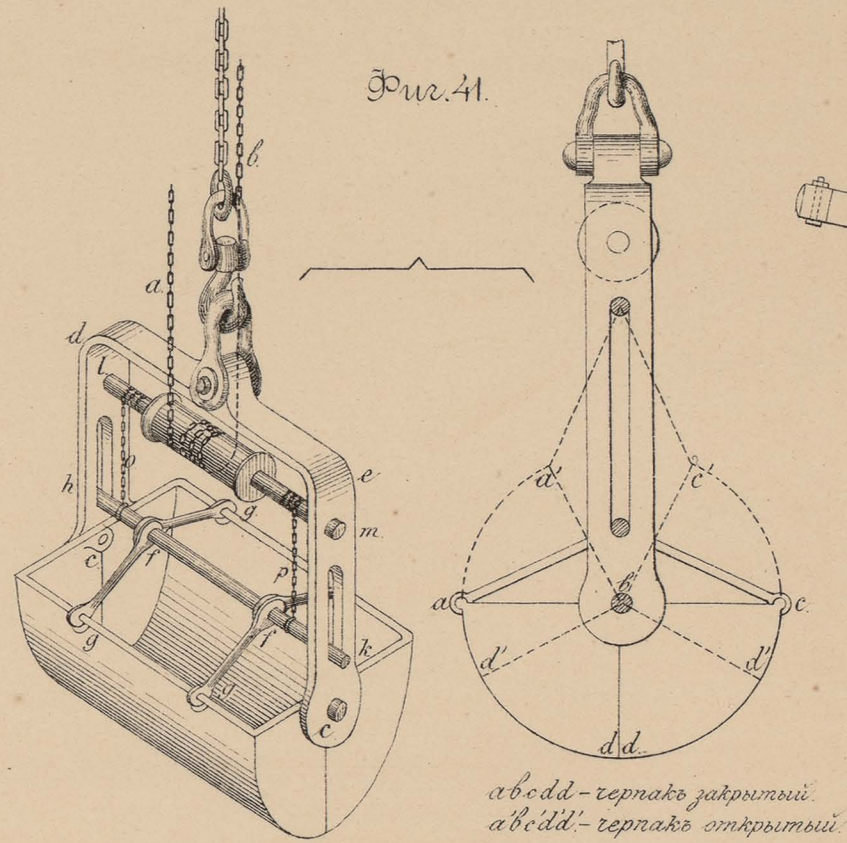

Фиг. 42.

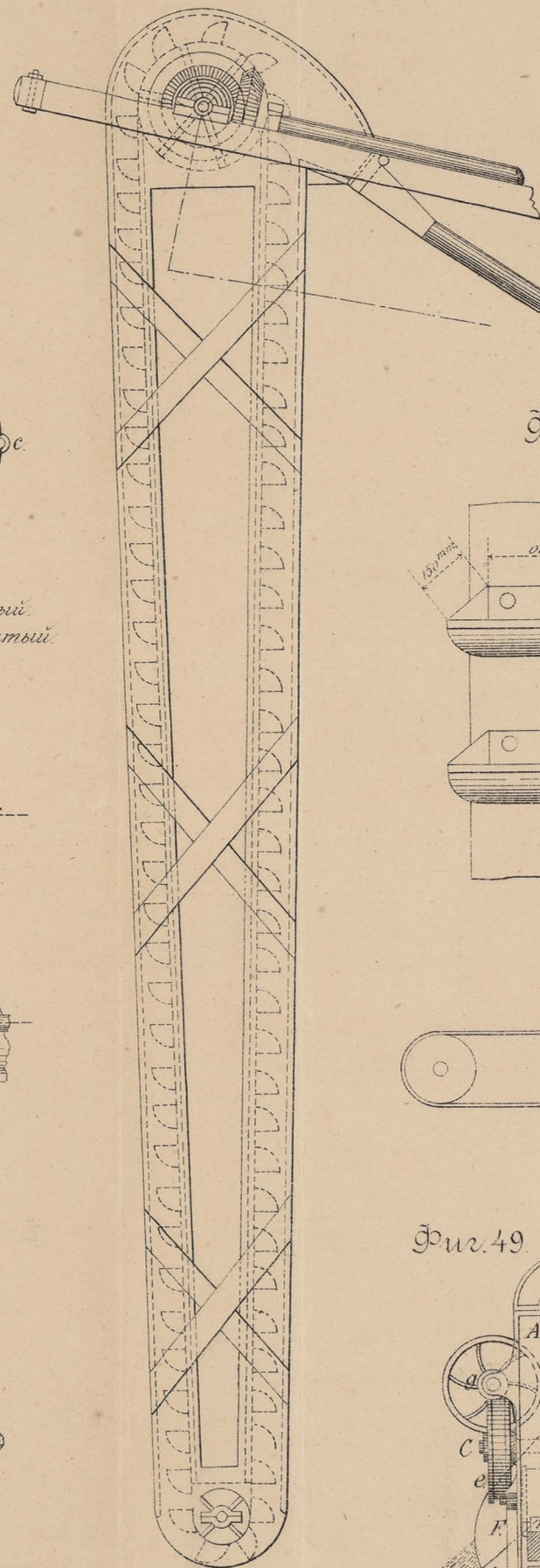

Фиг. 43.

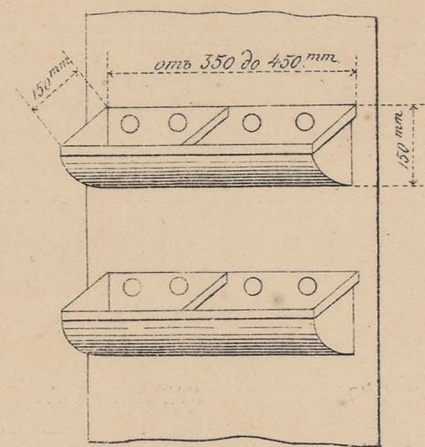

Фиг. 44.

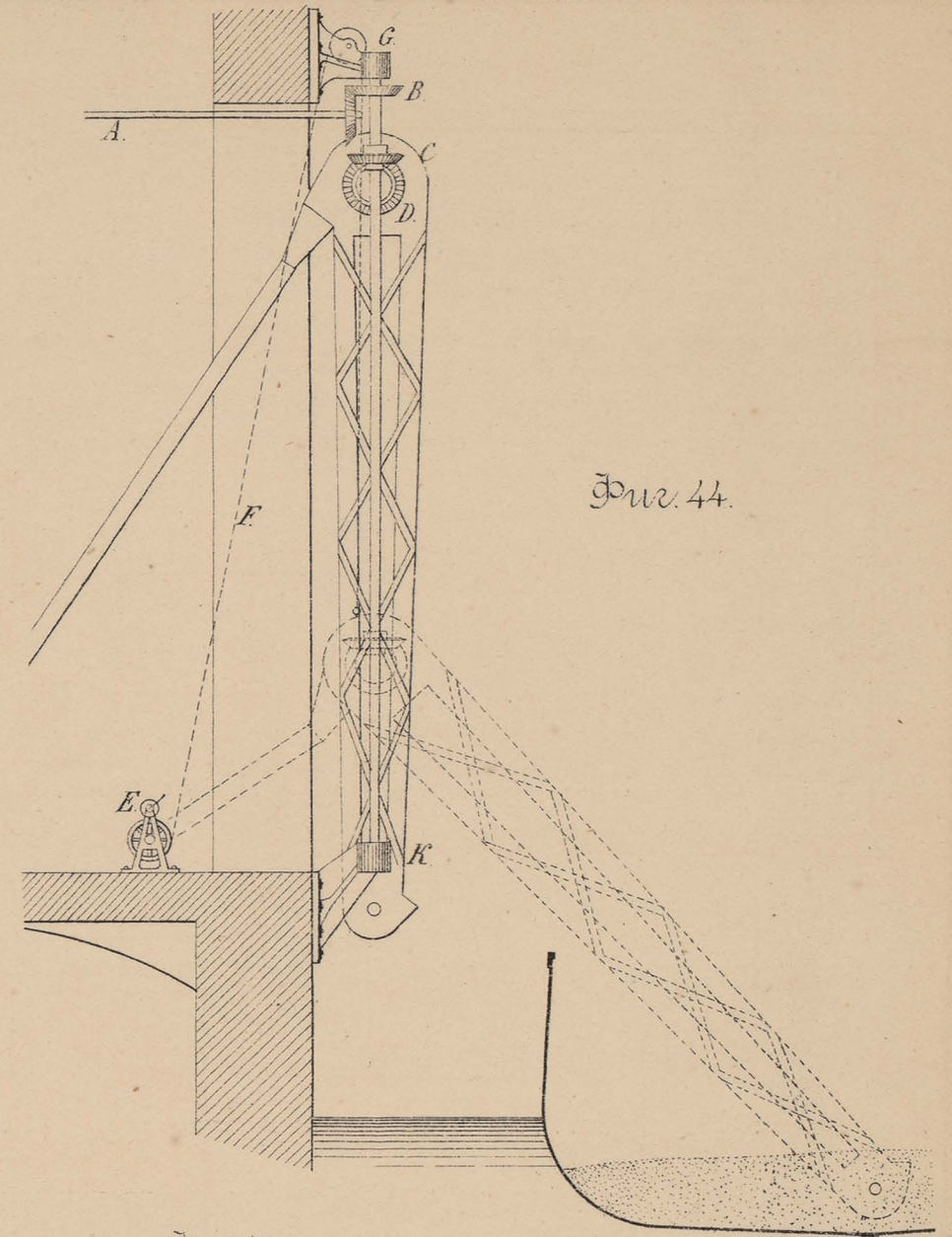

Фиг. 48.

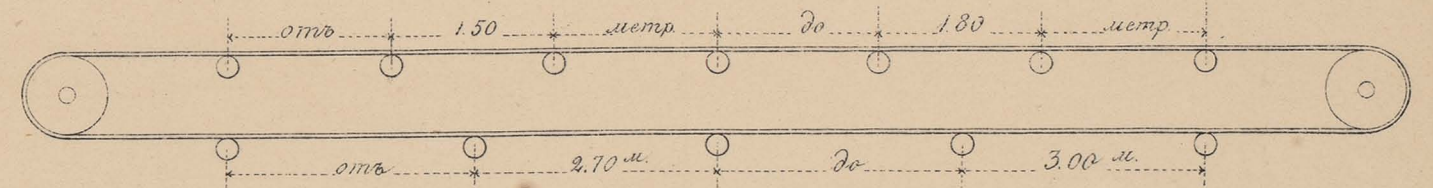

Фиг. 45.

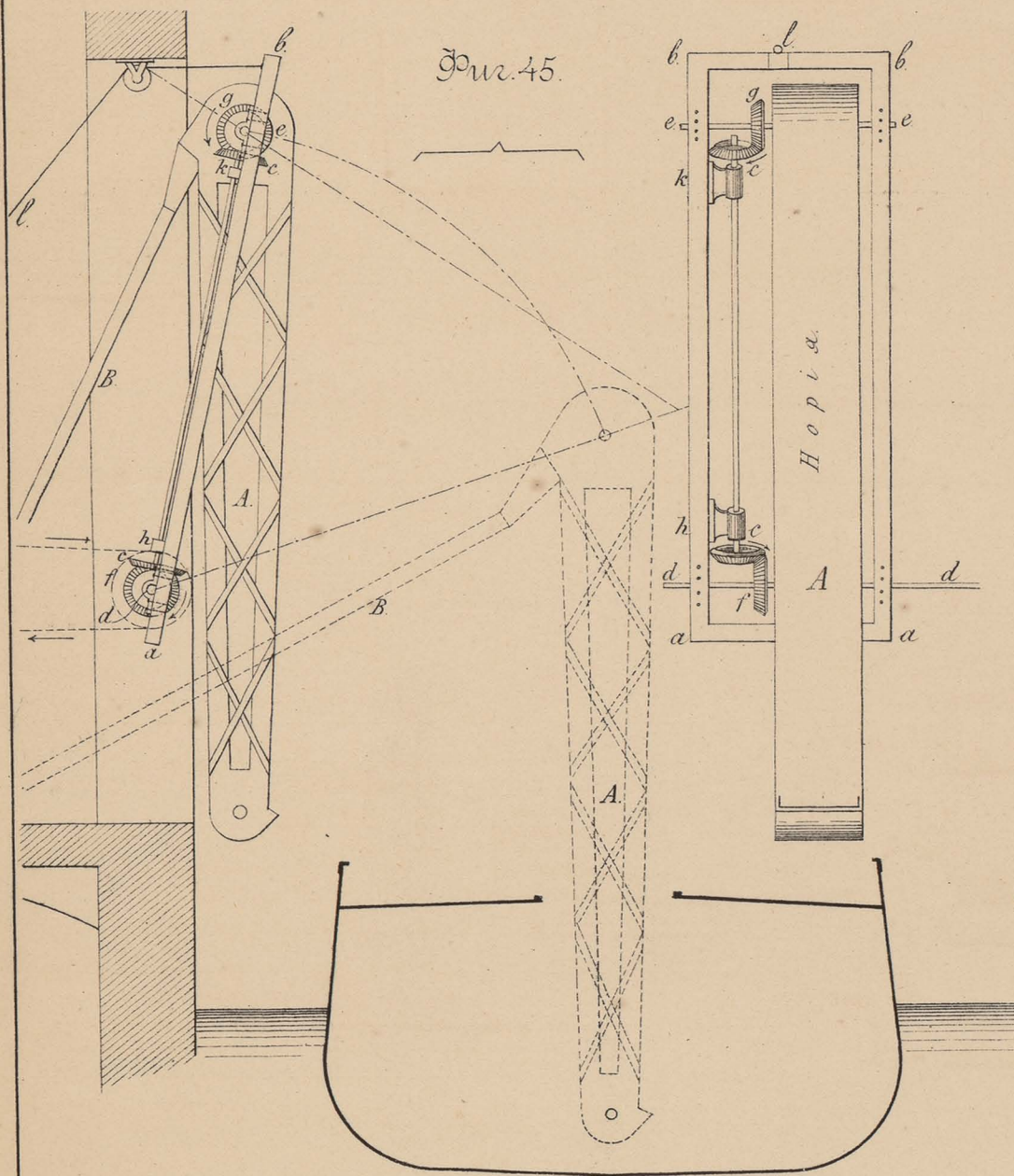

Фиг. 46.

Фасада.

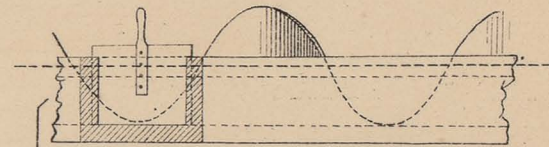

Плано.

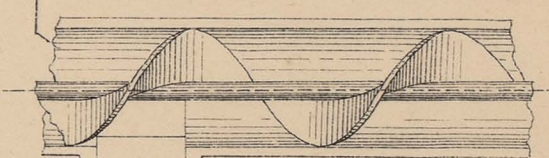

Разрѣзъ.

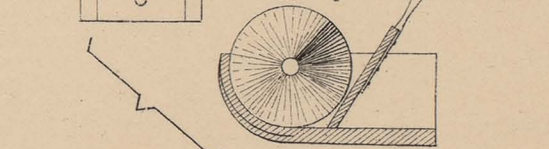

Фиг. 47.

Разрѣзъ по оси.

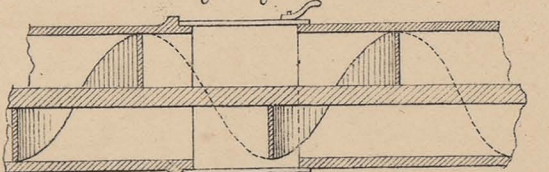

Поперечн. разрѣзъ.

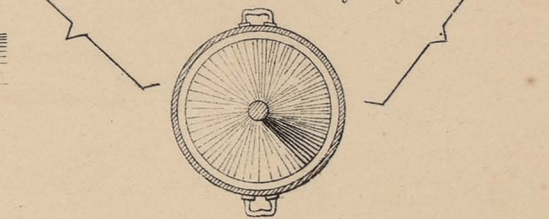

Фиг. 49.

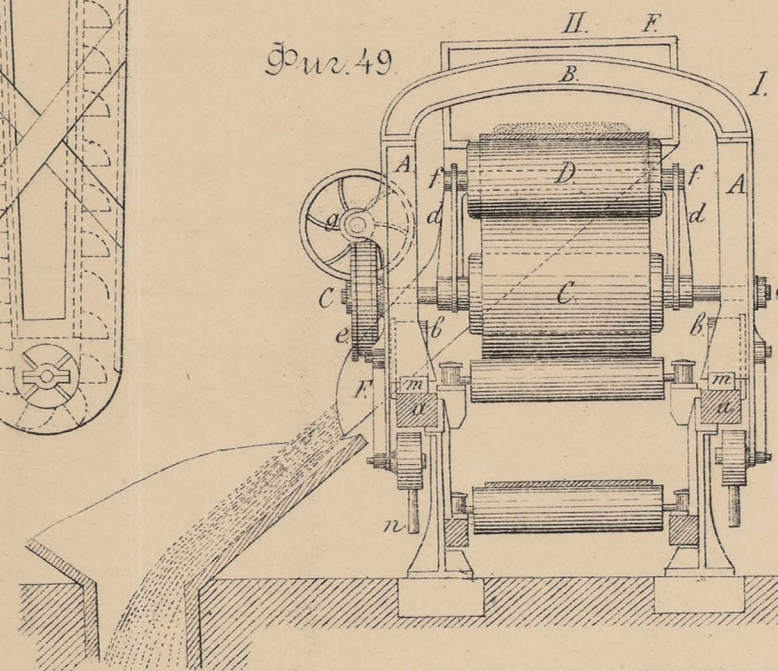

Фиг. 50.

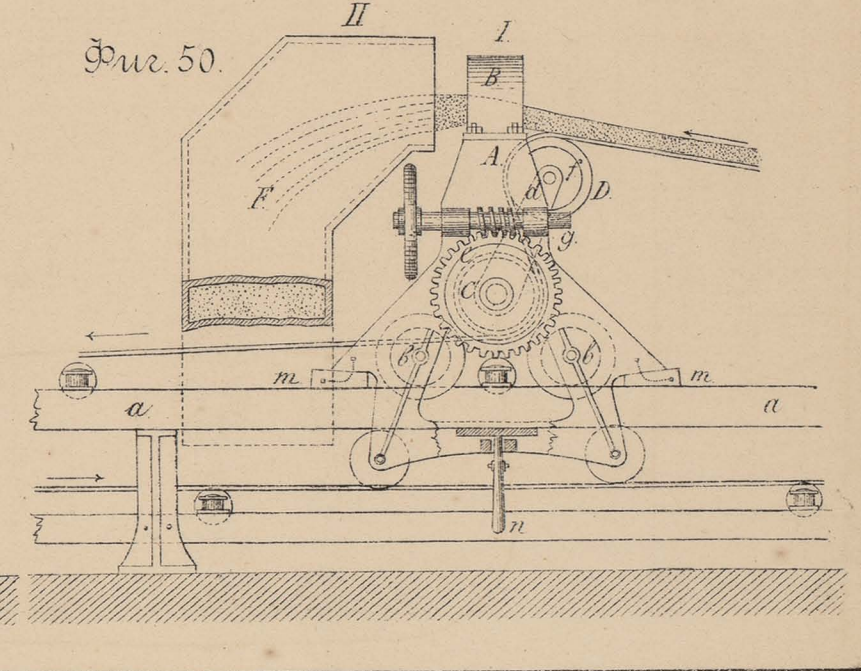











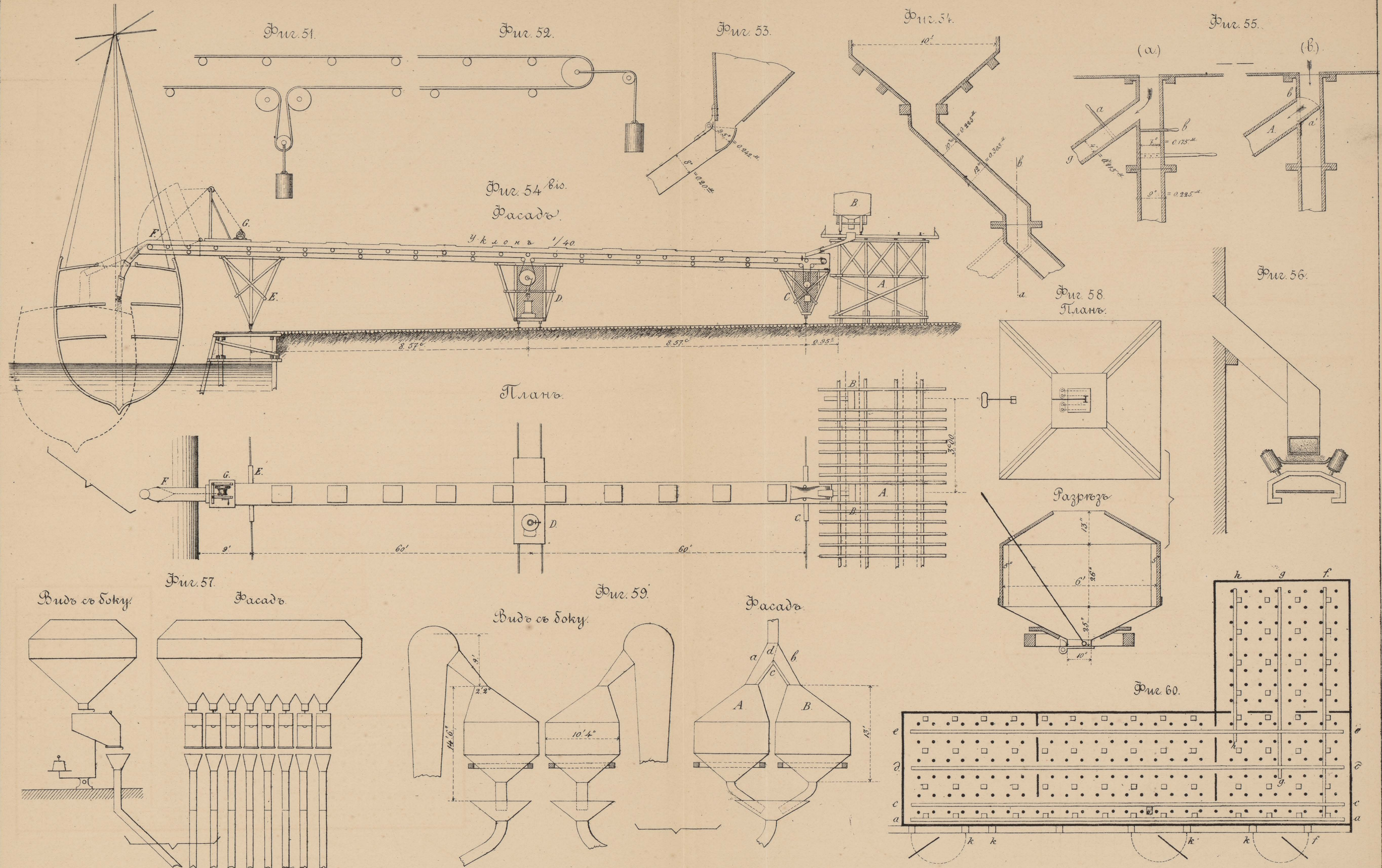











Фиг. 61.

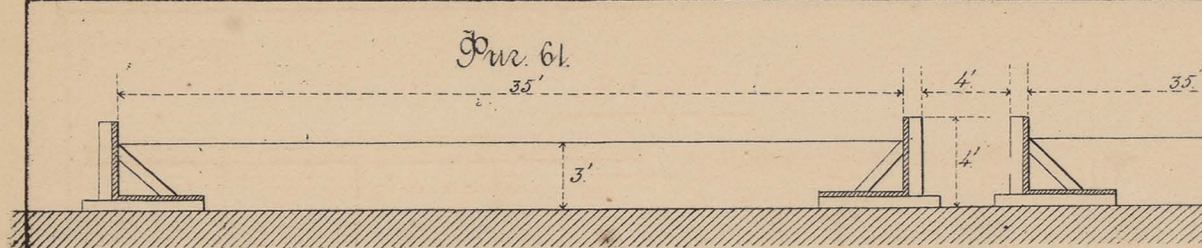

Фиг. 62.

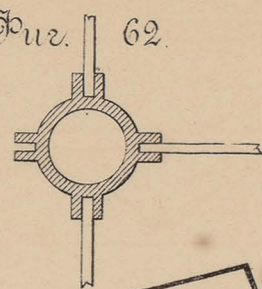

Фиг. 67.

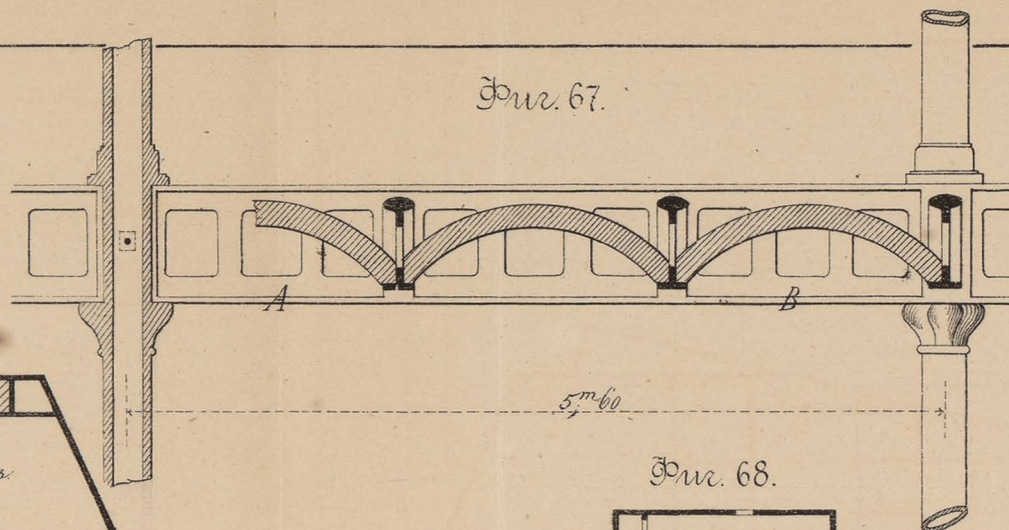

Фиг. 69.

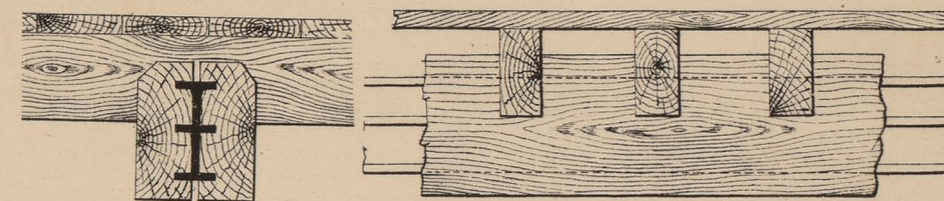

Фиг. 63.

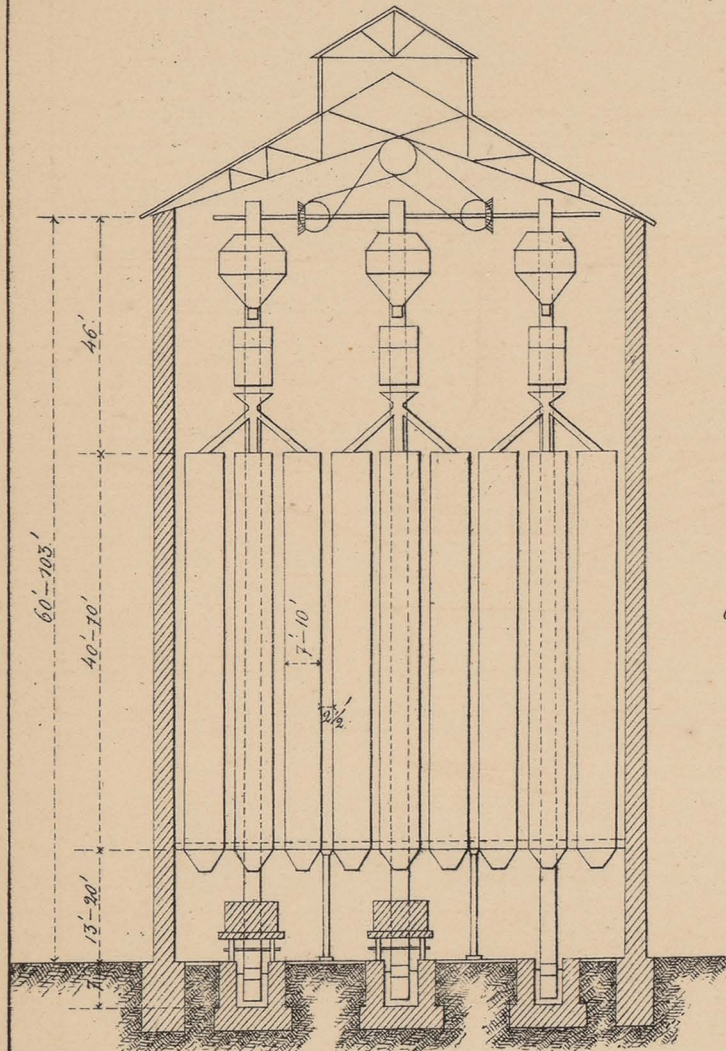

Фиг. 64.

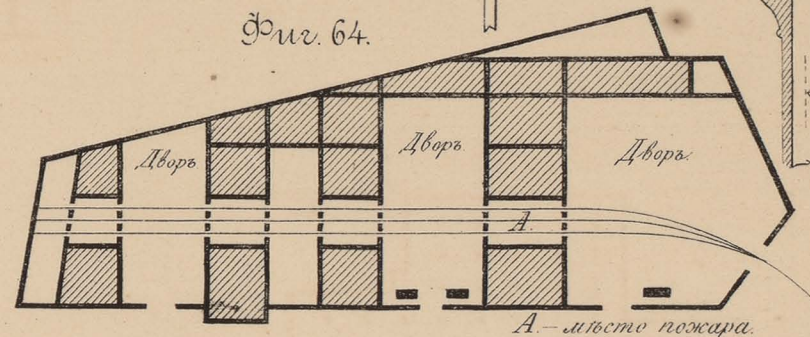

Фиг. 71.

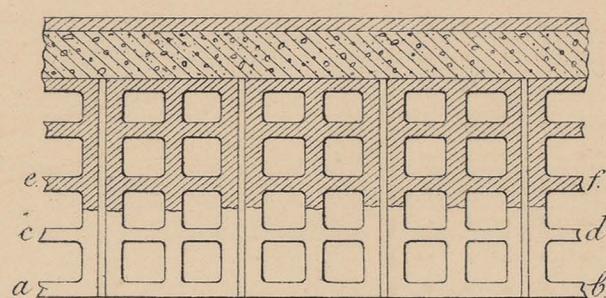

Фиг. 66.

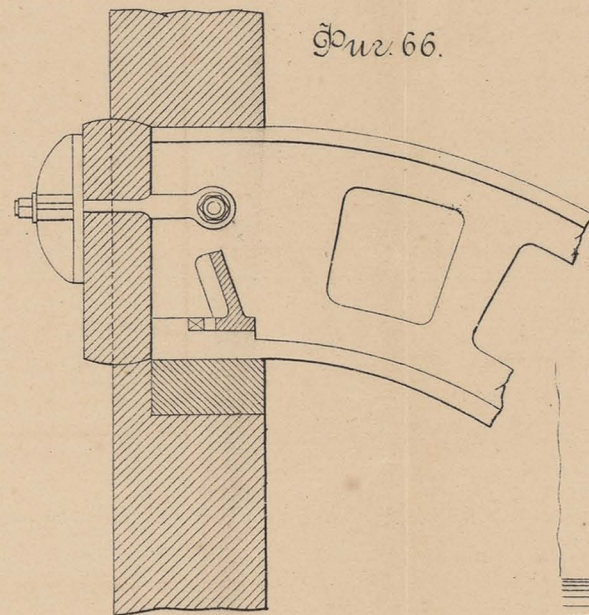

Фиг. 68.

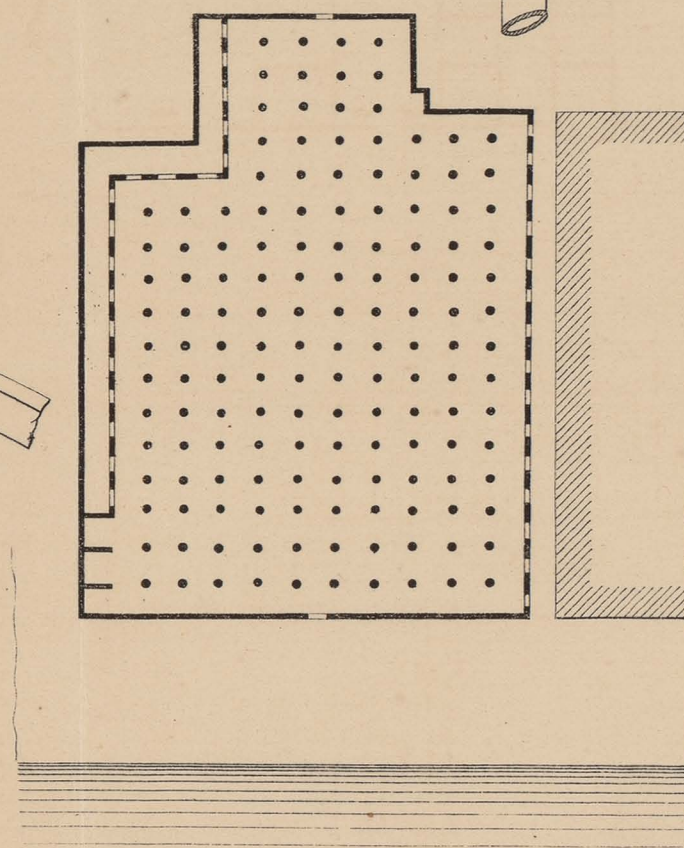

Фиг. 70.

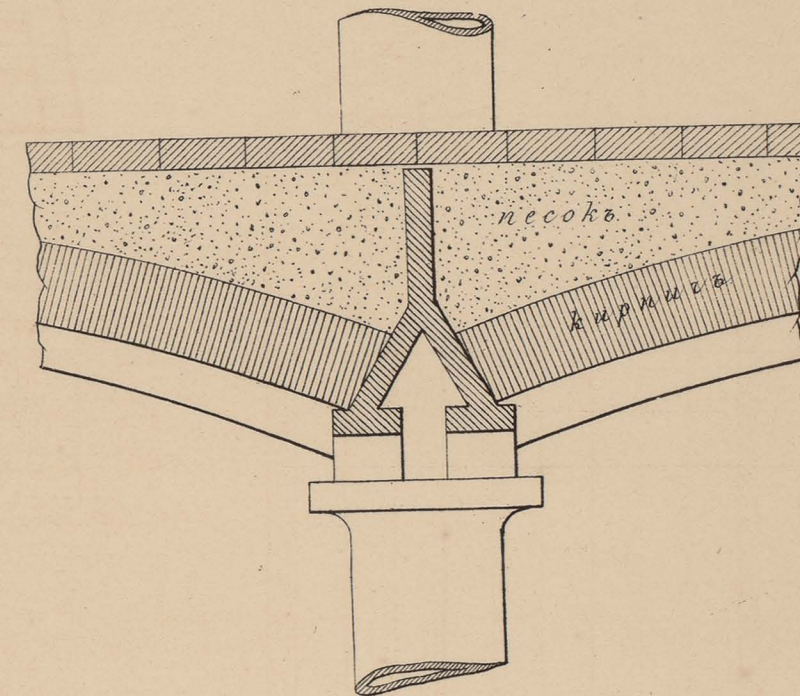

Фиг. 65.

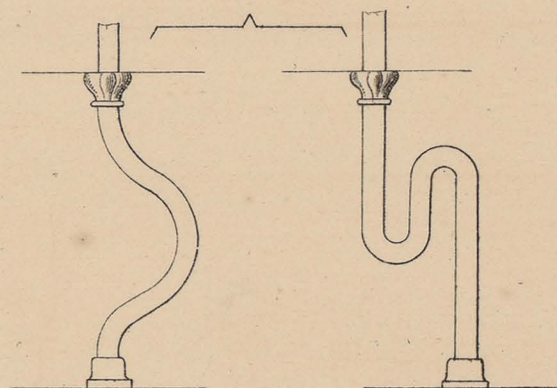

Фиг. 73.

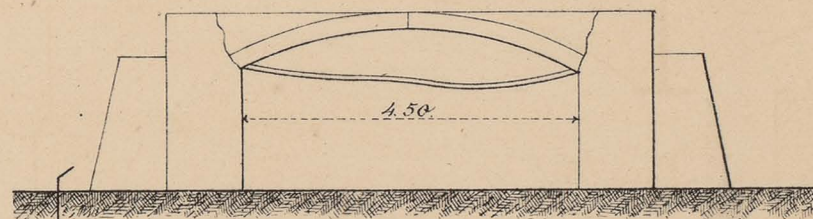

Фиг. 74.

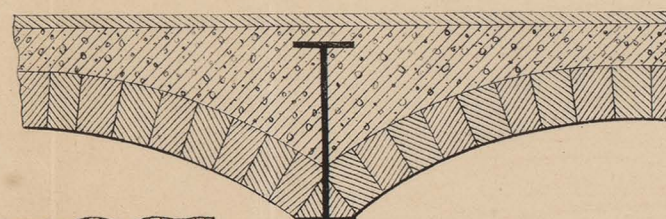

Фиг. 75.

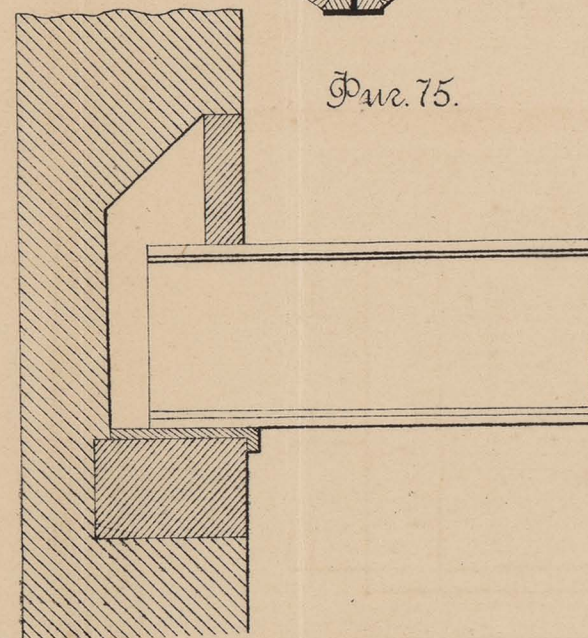

Фиг. 70 bis (a)

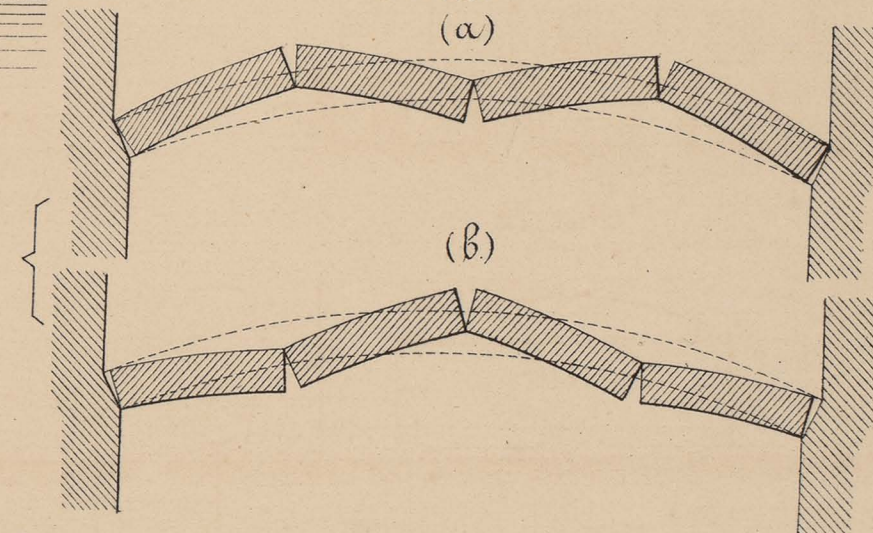

(b)

Фиг. 72.

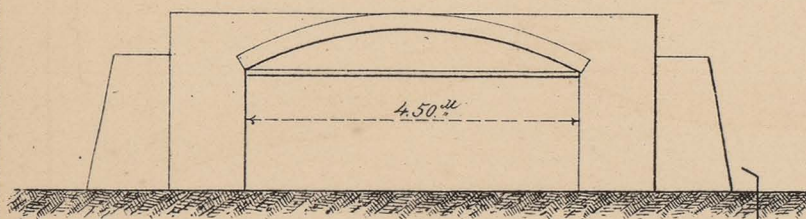

Планъ.

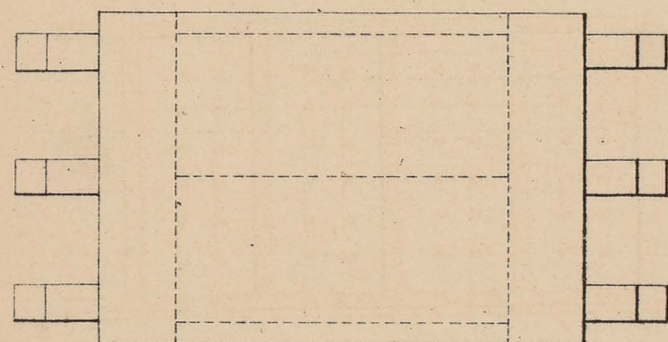

Планъ.

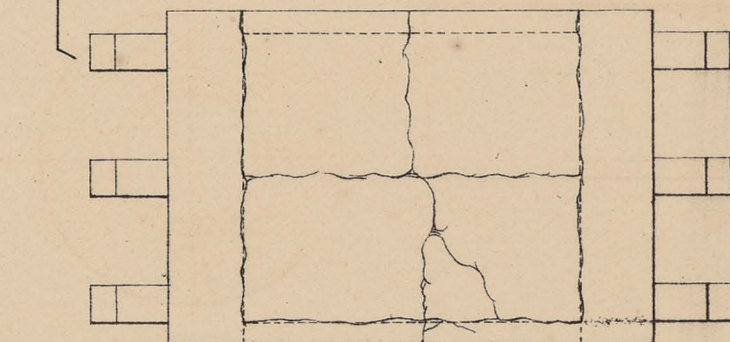

Фиг. 76.

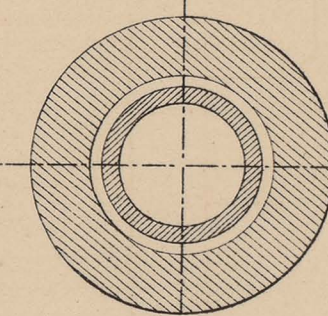

Фиг. 77.

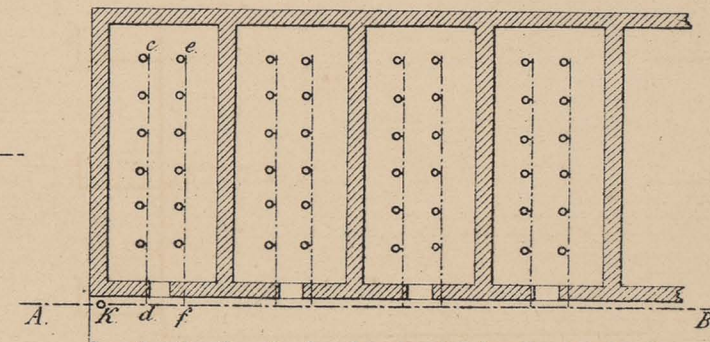











Фиг. 78.

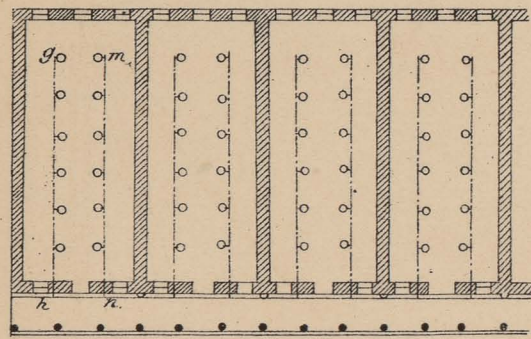

Фиг. 79.

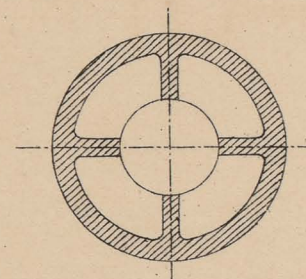

Фиг. 85.

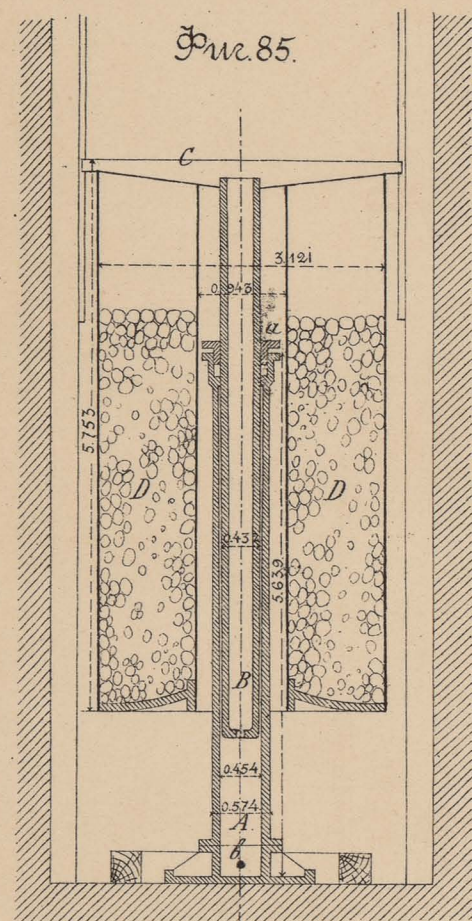

Фиг. 80.

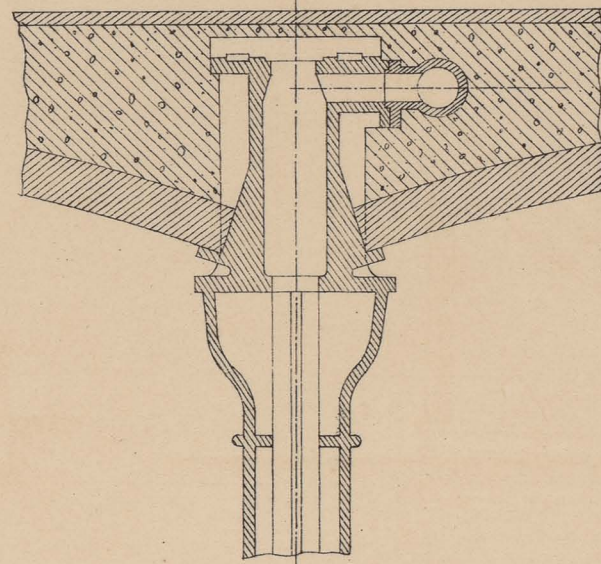

Фиг. 81.

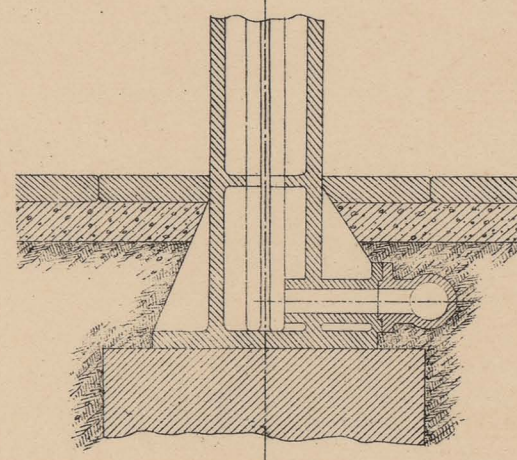

Фиг. 82.

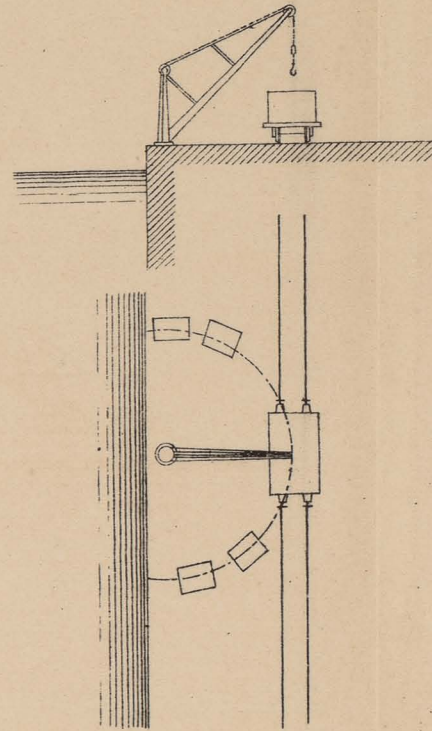

Фиг. 86.

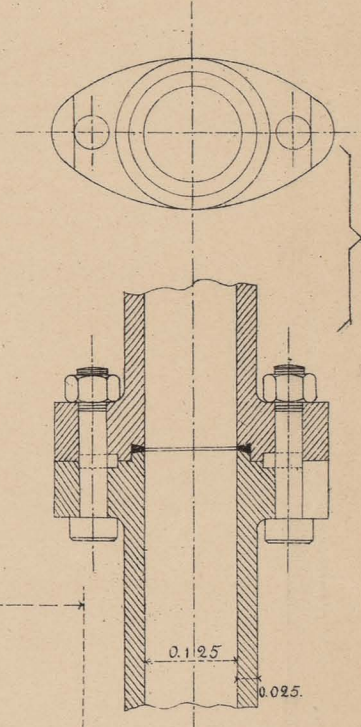

Фиг. 87.

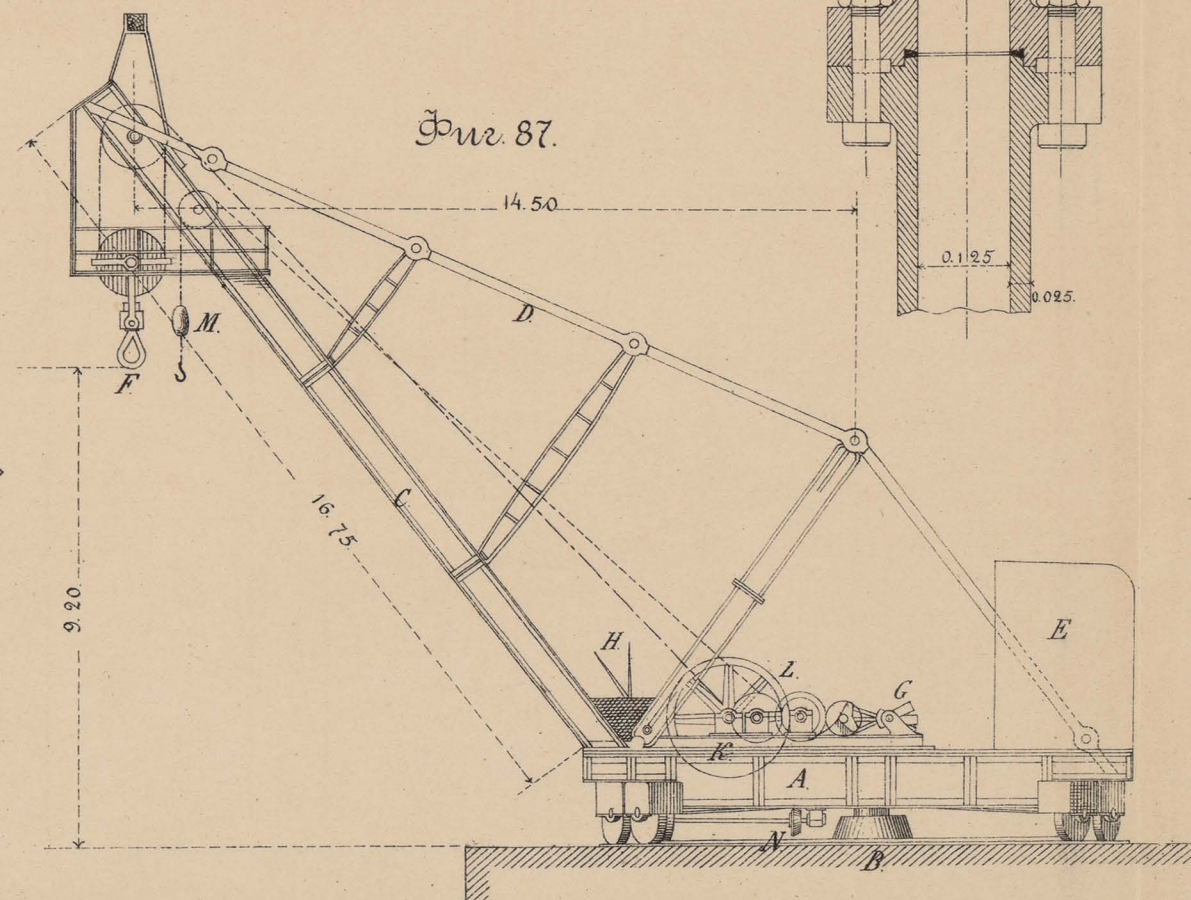

Фиг. 83.

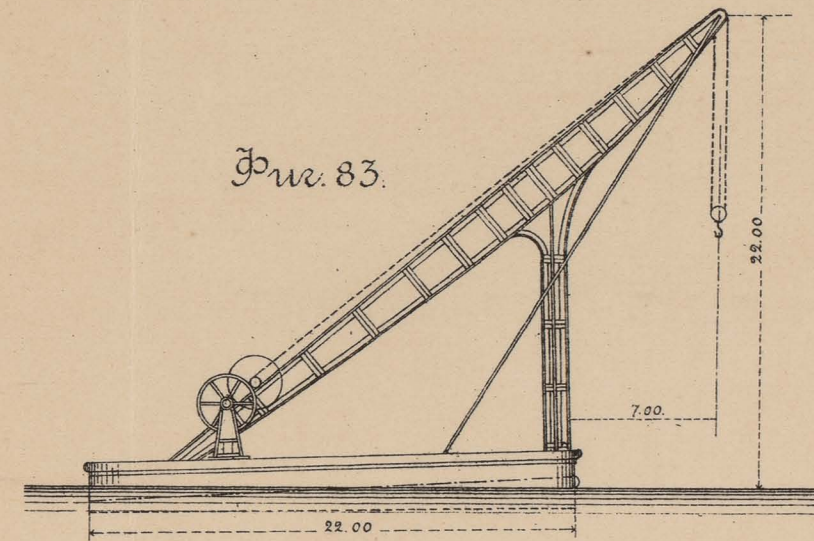

Фиг. 84.

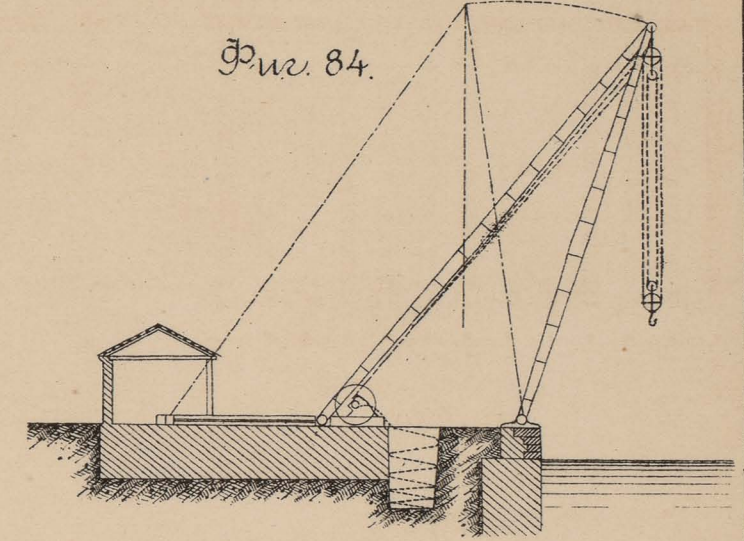

Фиг. 88.

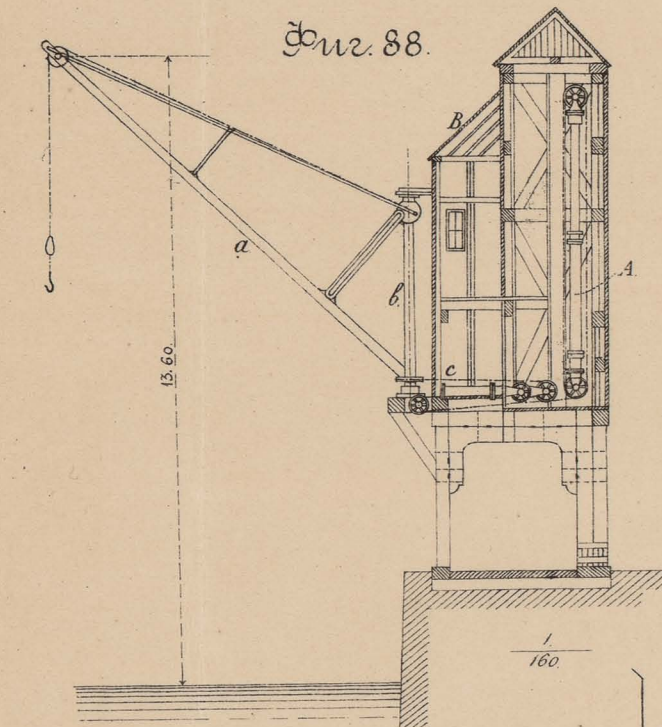

Фиг. 89.

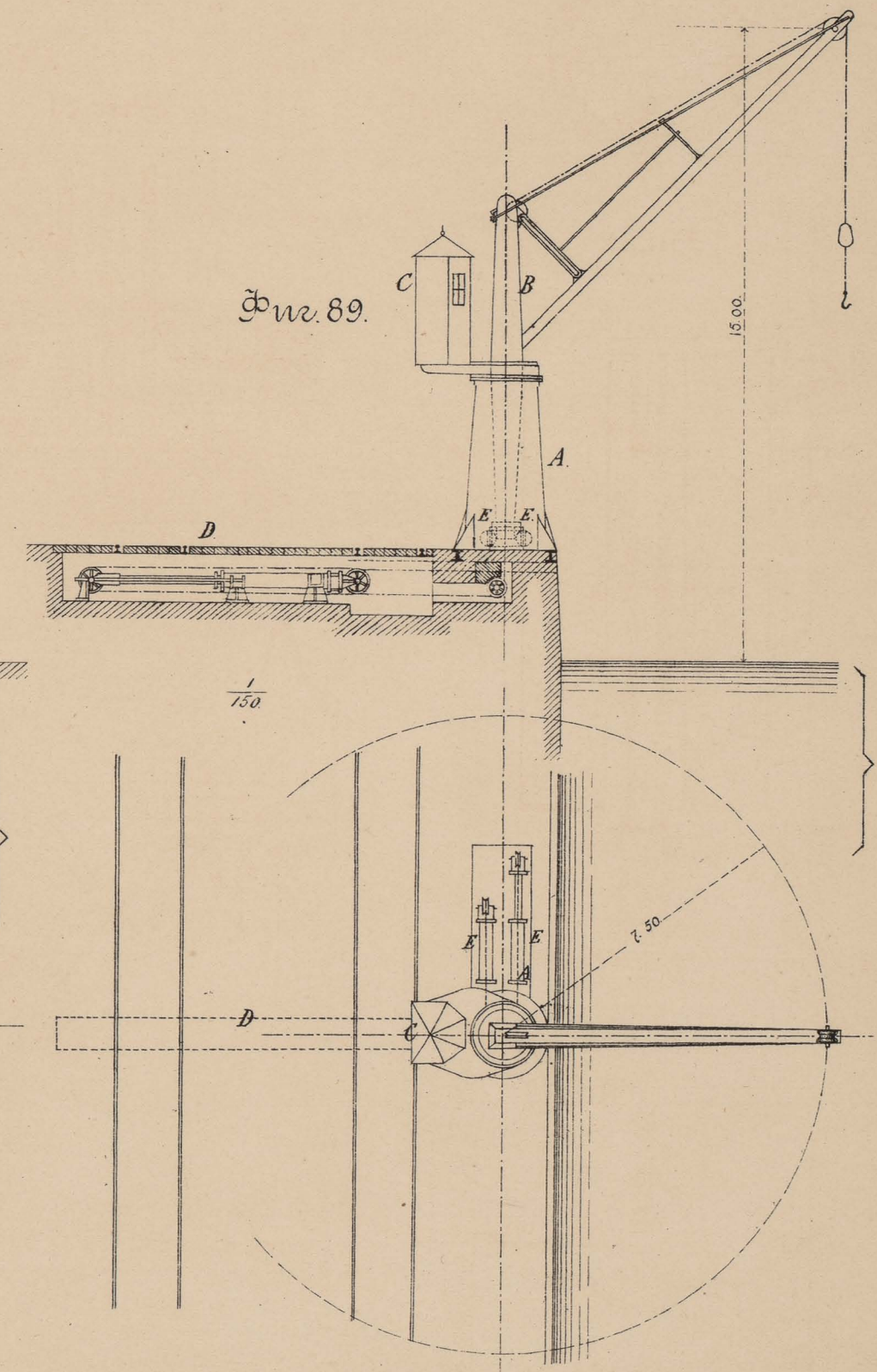











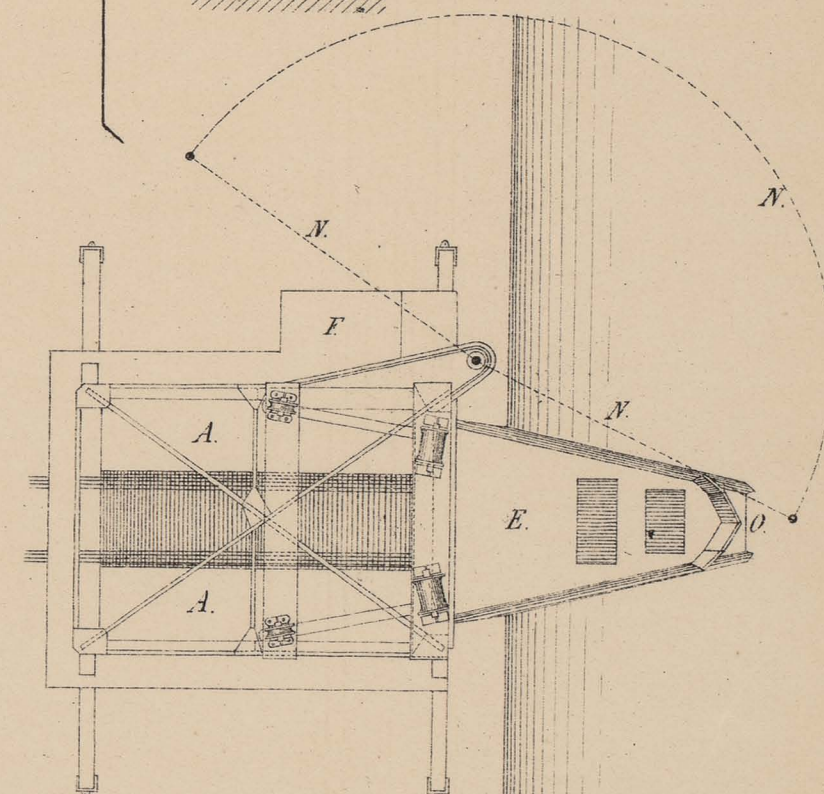
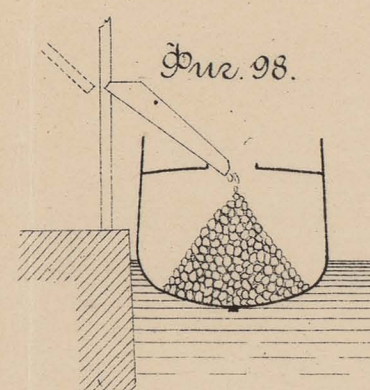
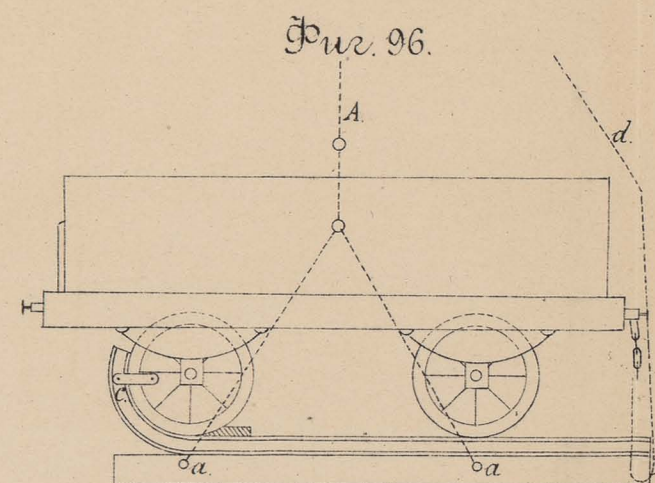
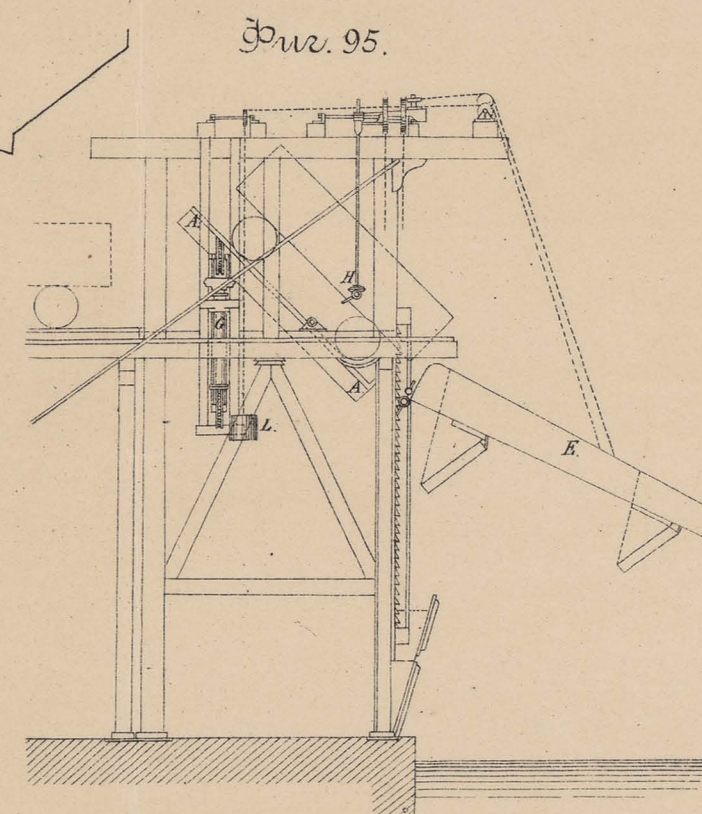
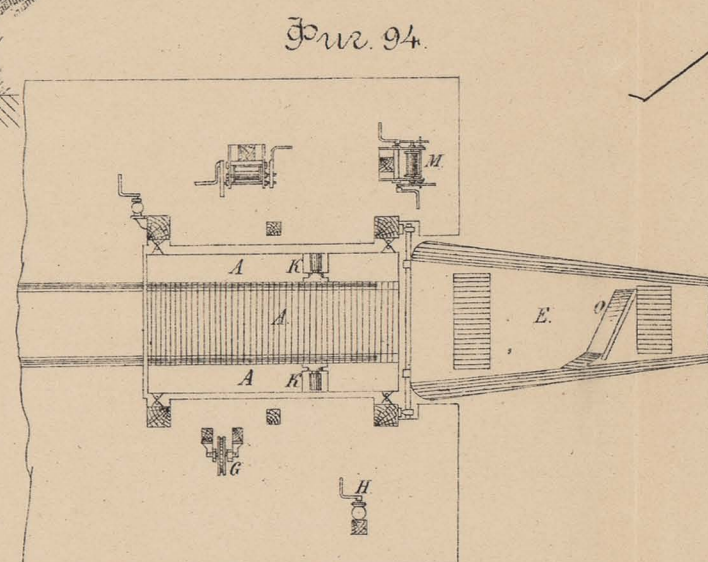
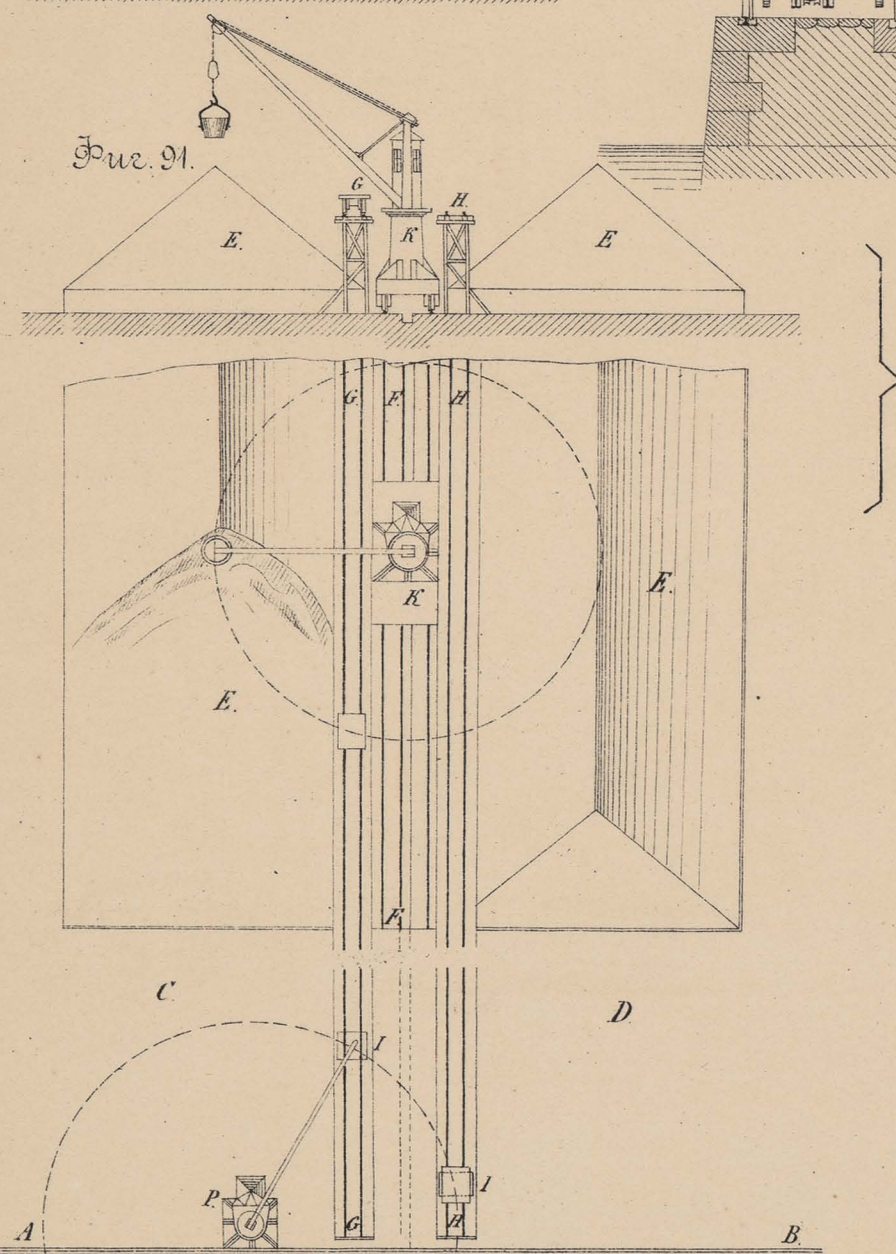
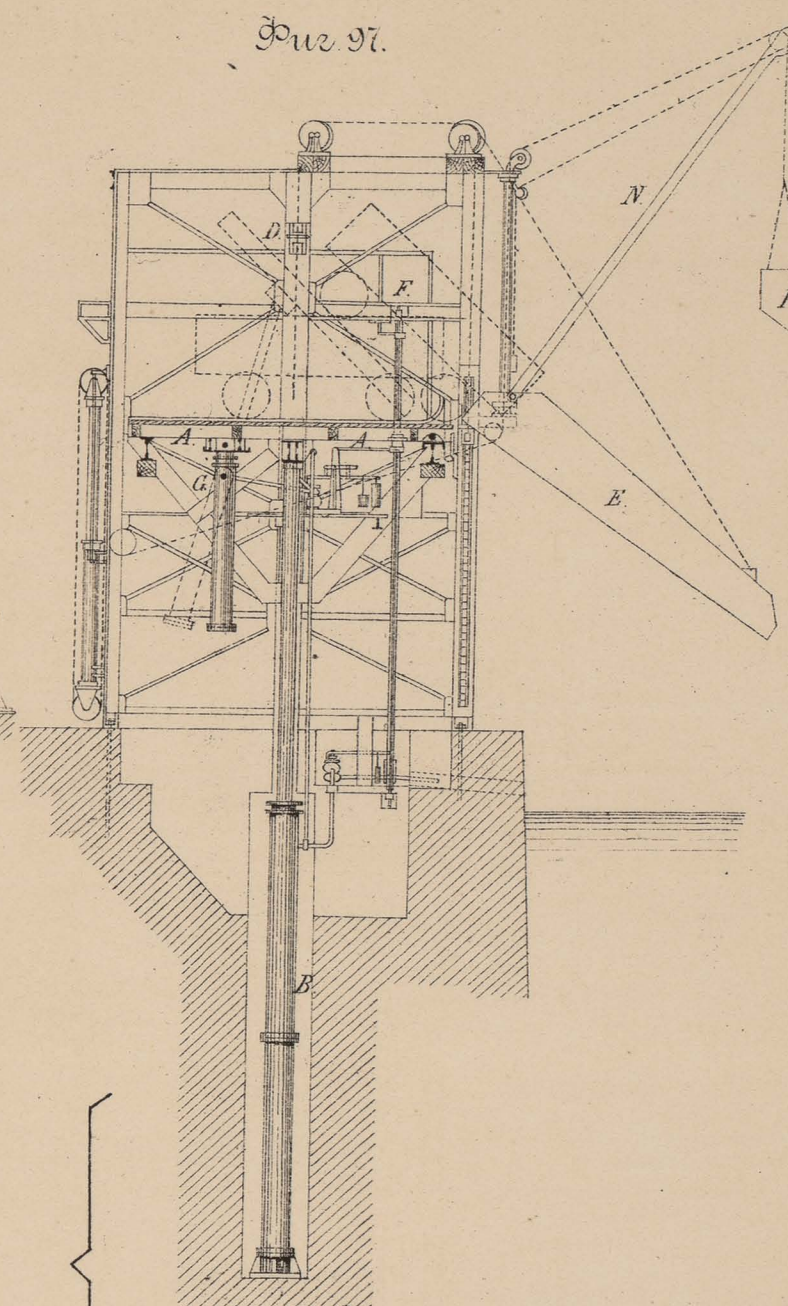
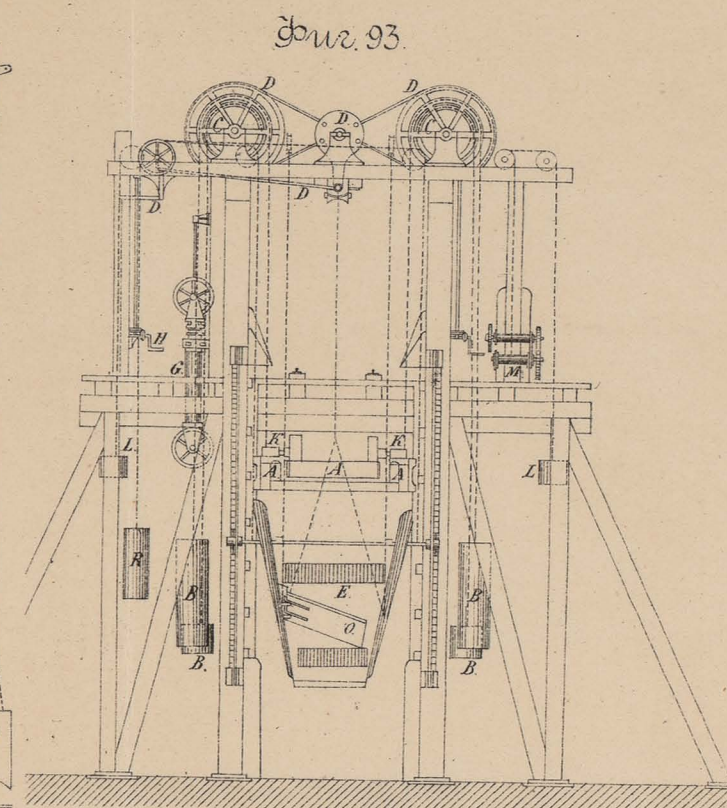
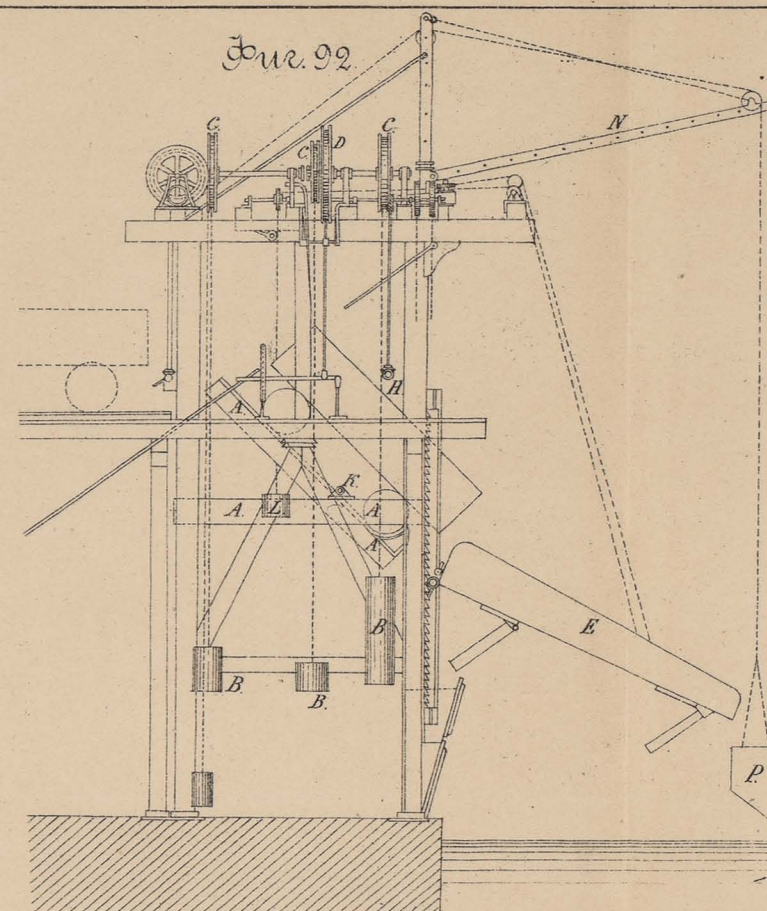
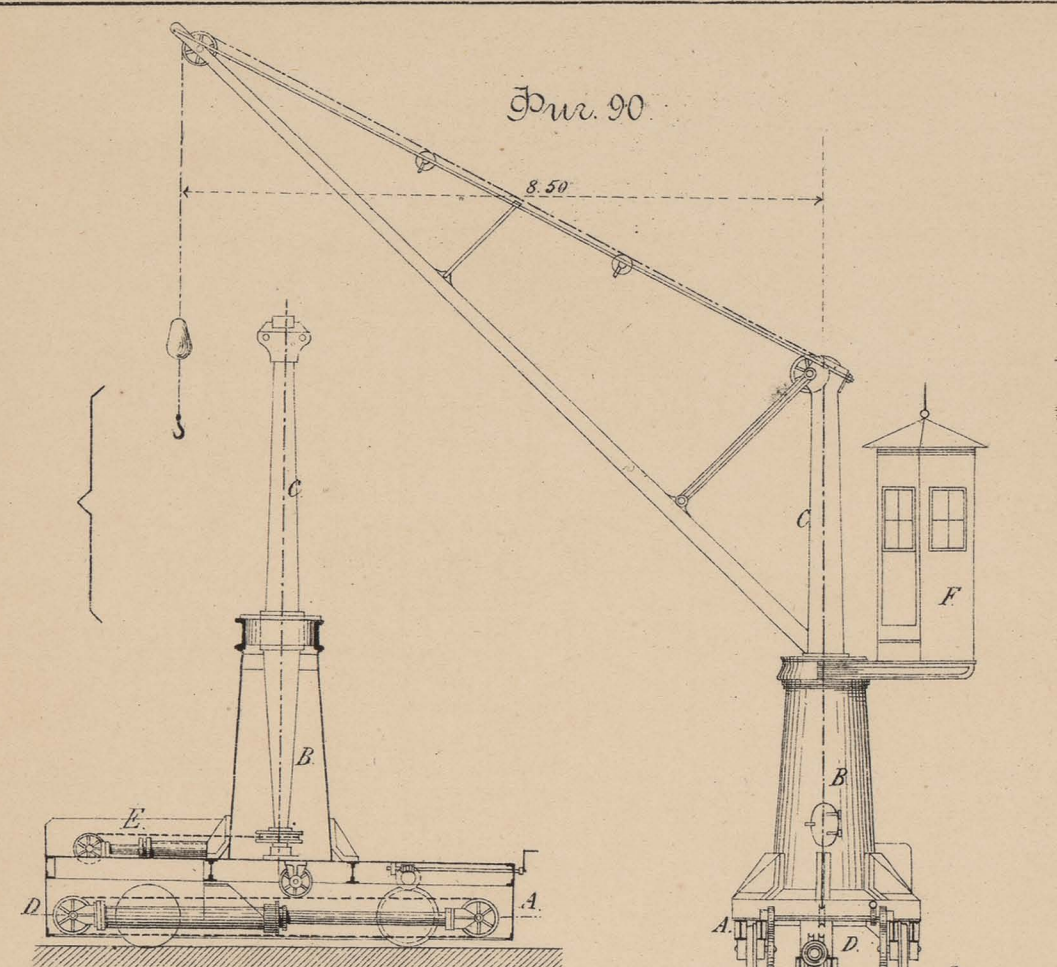











Видъ со боку.

Фиг. 99.

Фасада.

Фиг. 102.

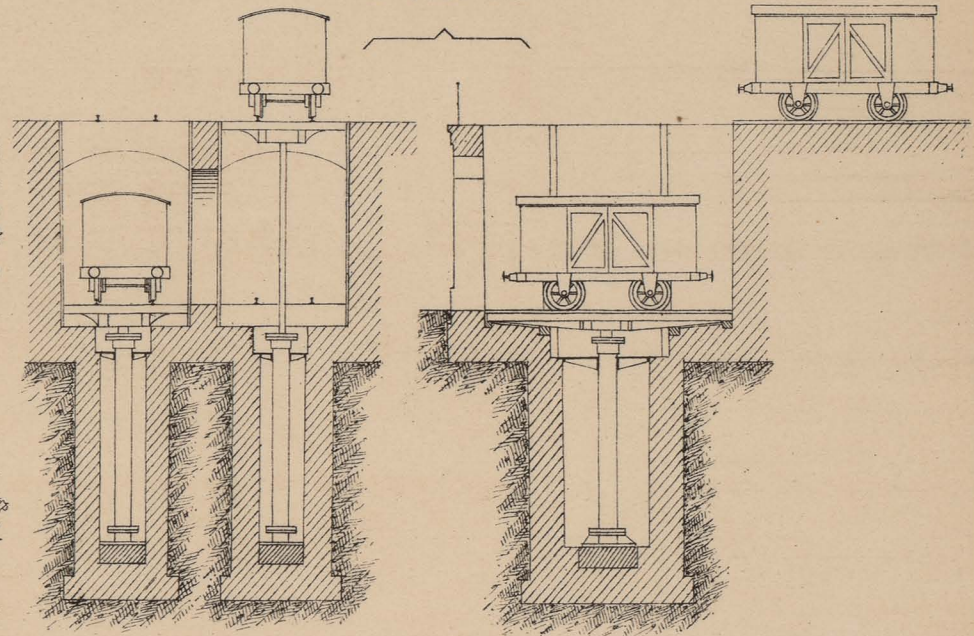
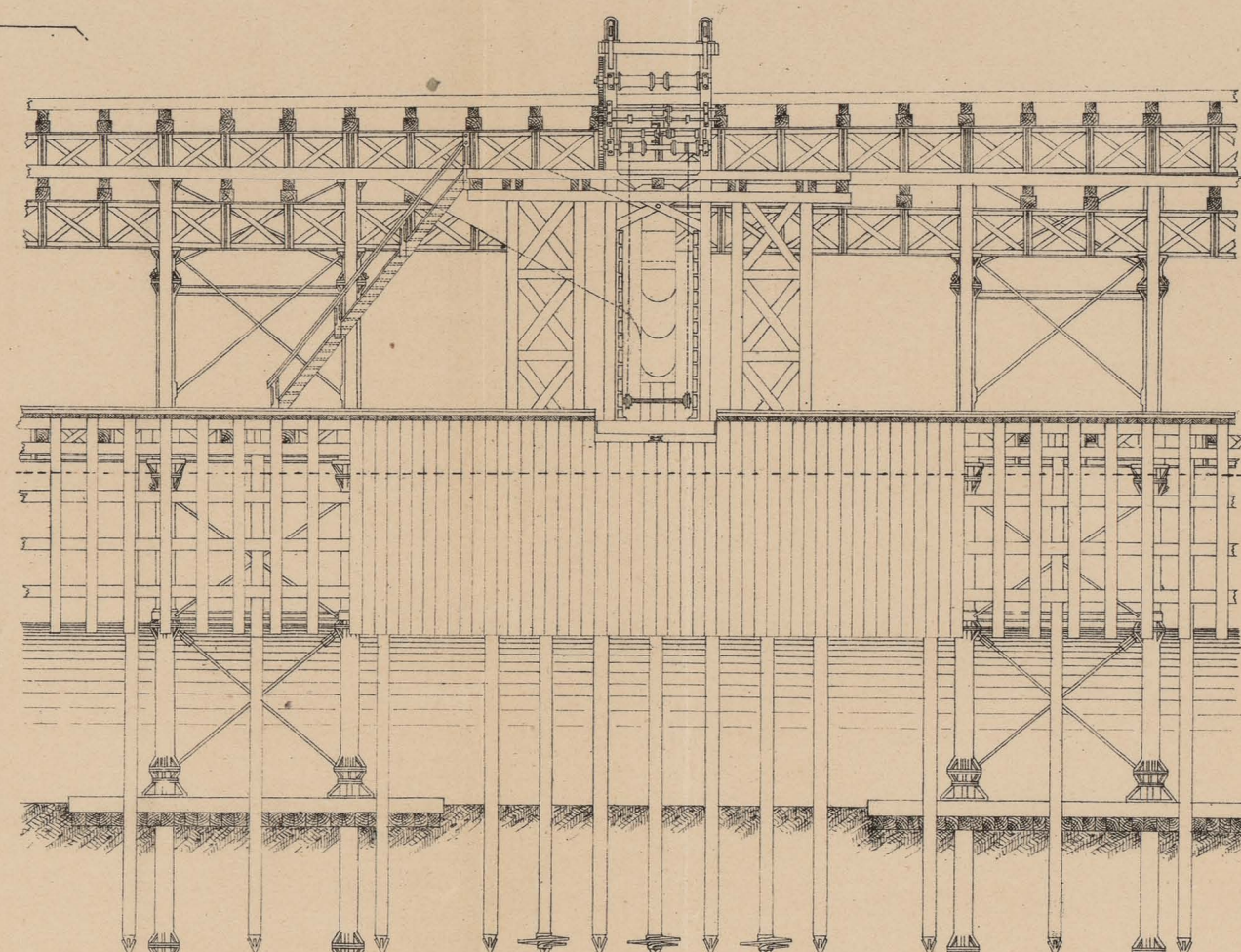
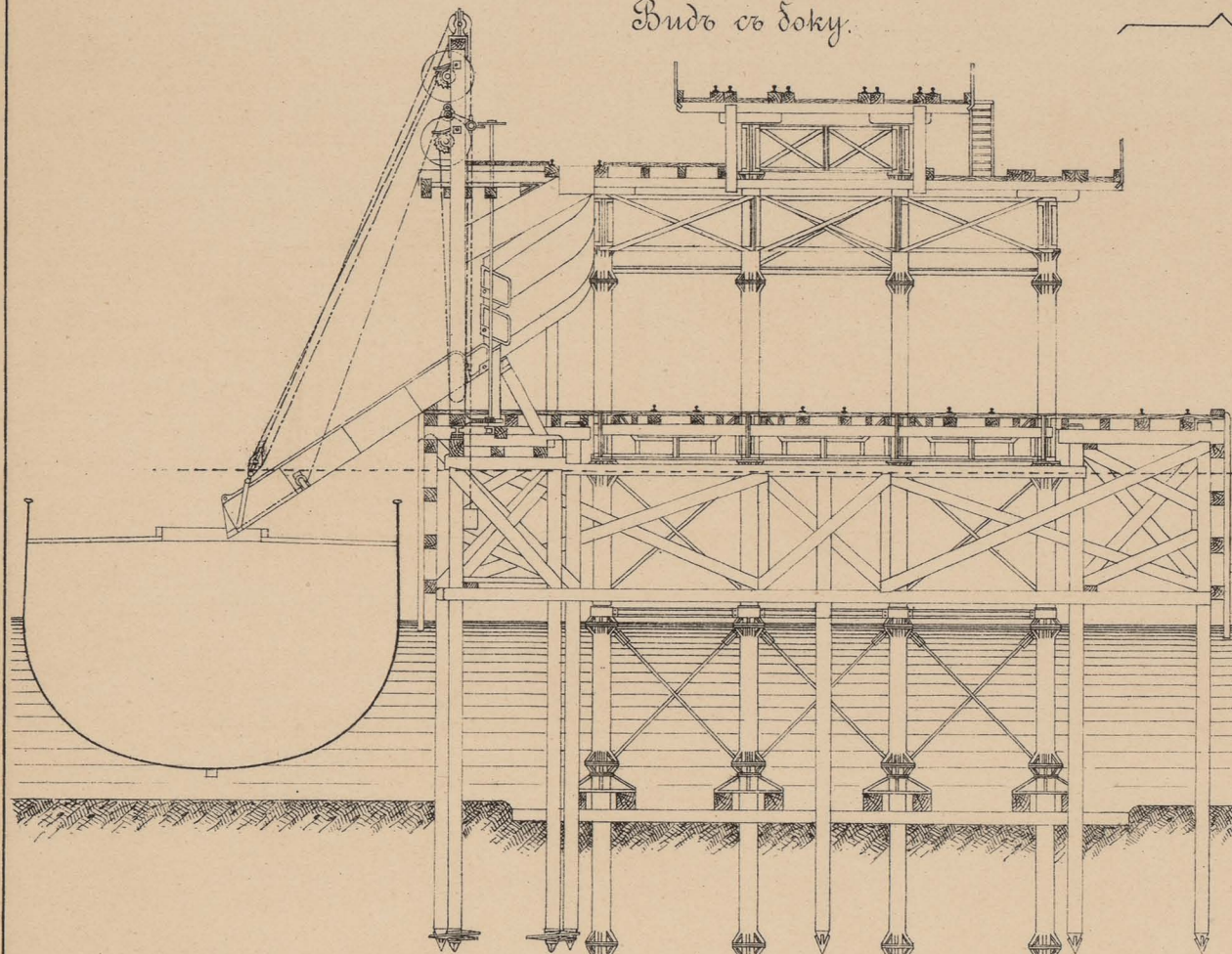

Фиг. 100.

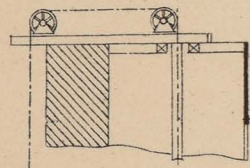

Фиг. 101.

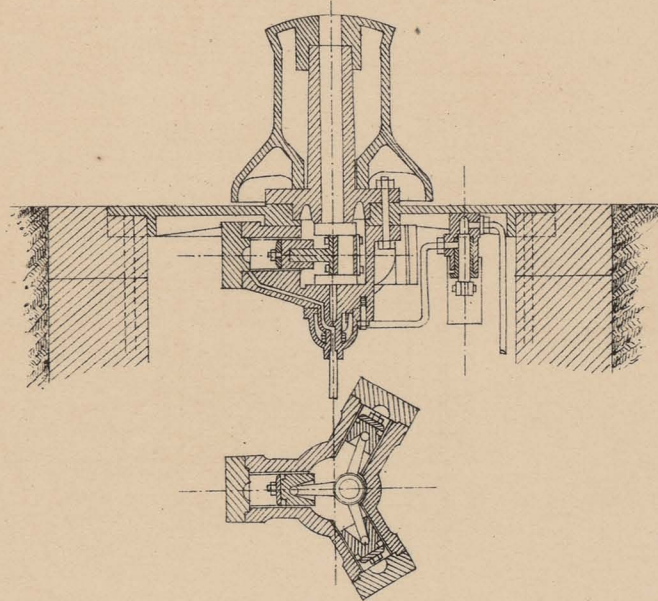

Фиг. 103.

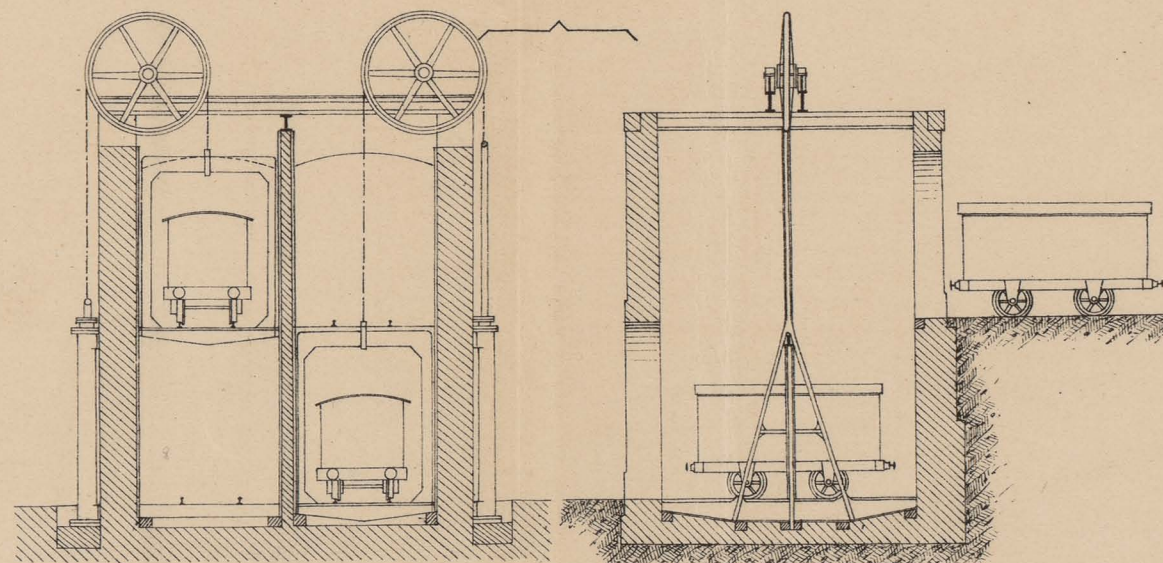

Фиг. 105.

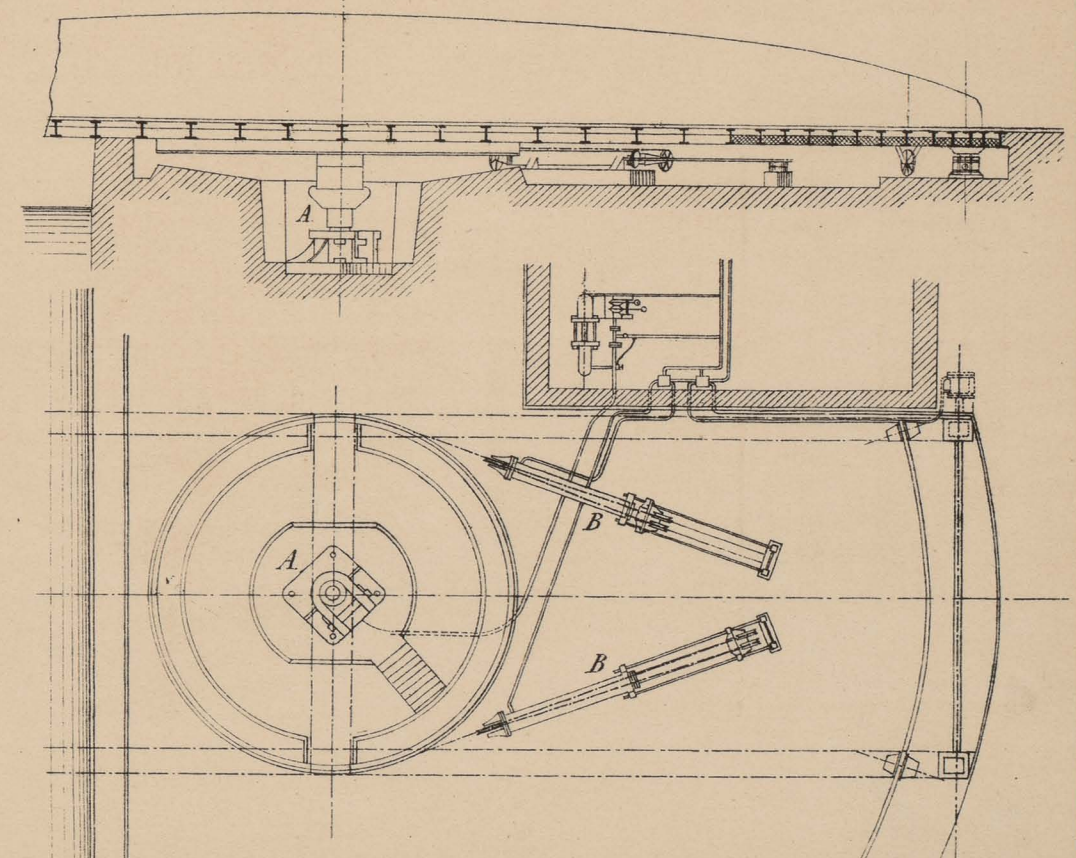











Фиг. 106.

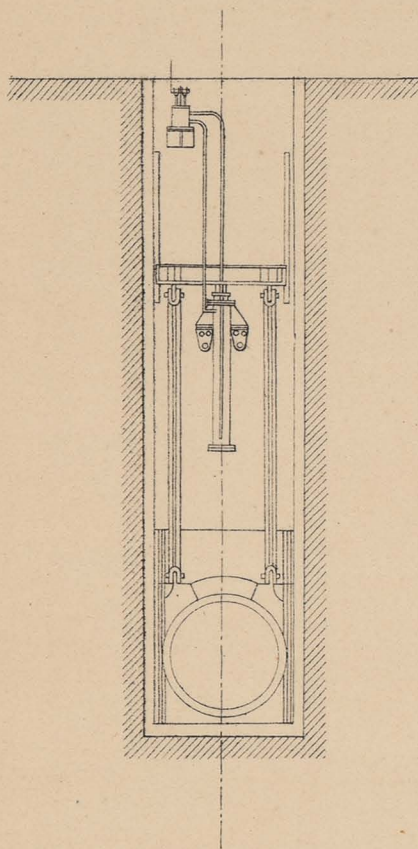

Фиг. 108.

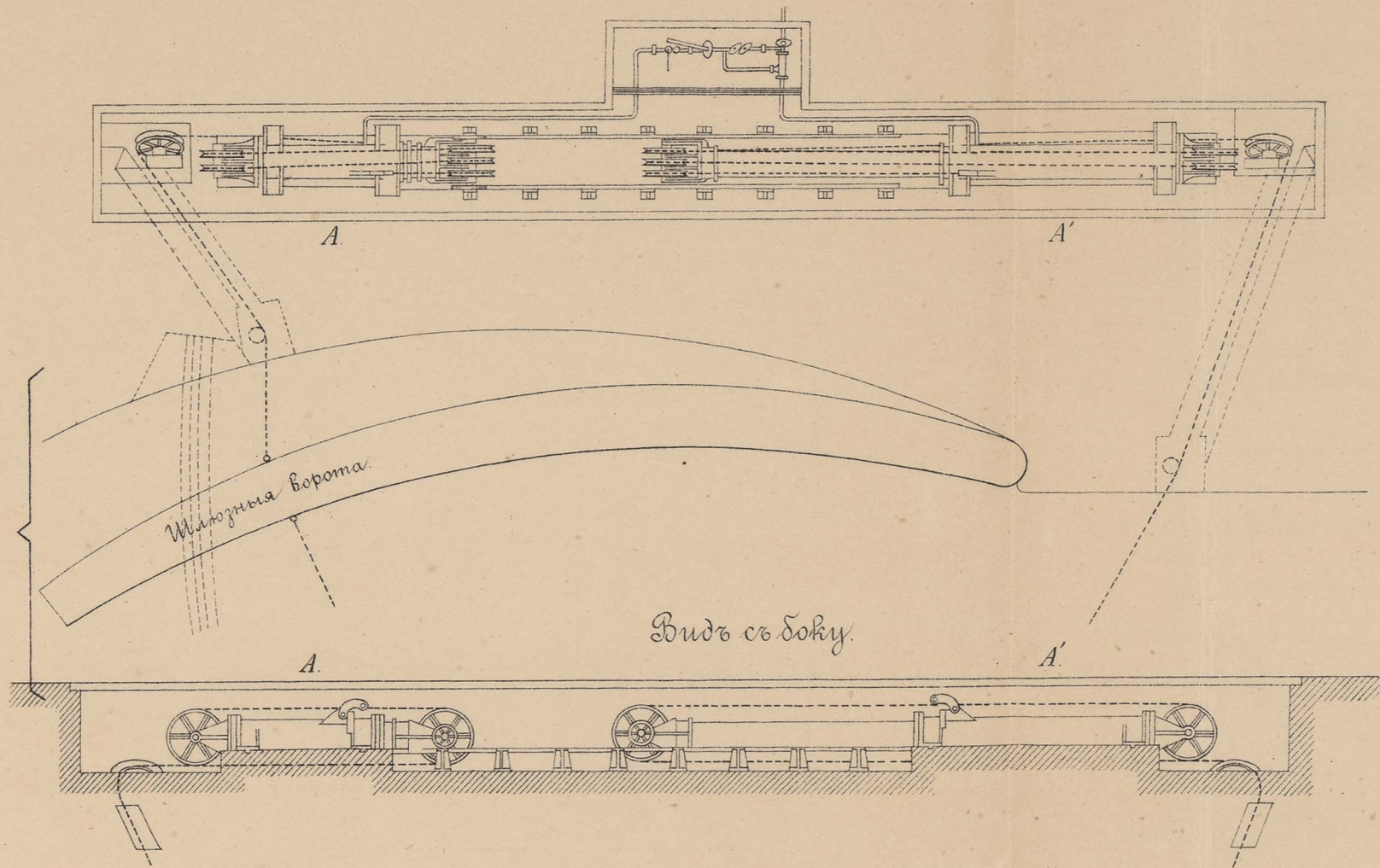

Фиг. 109.

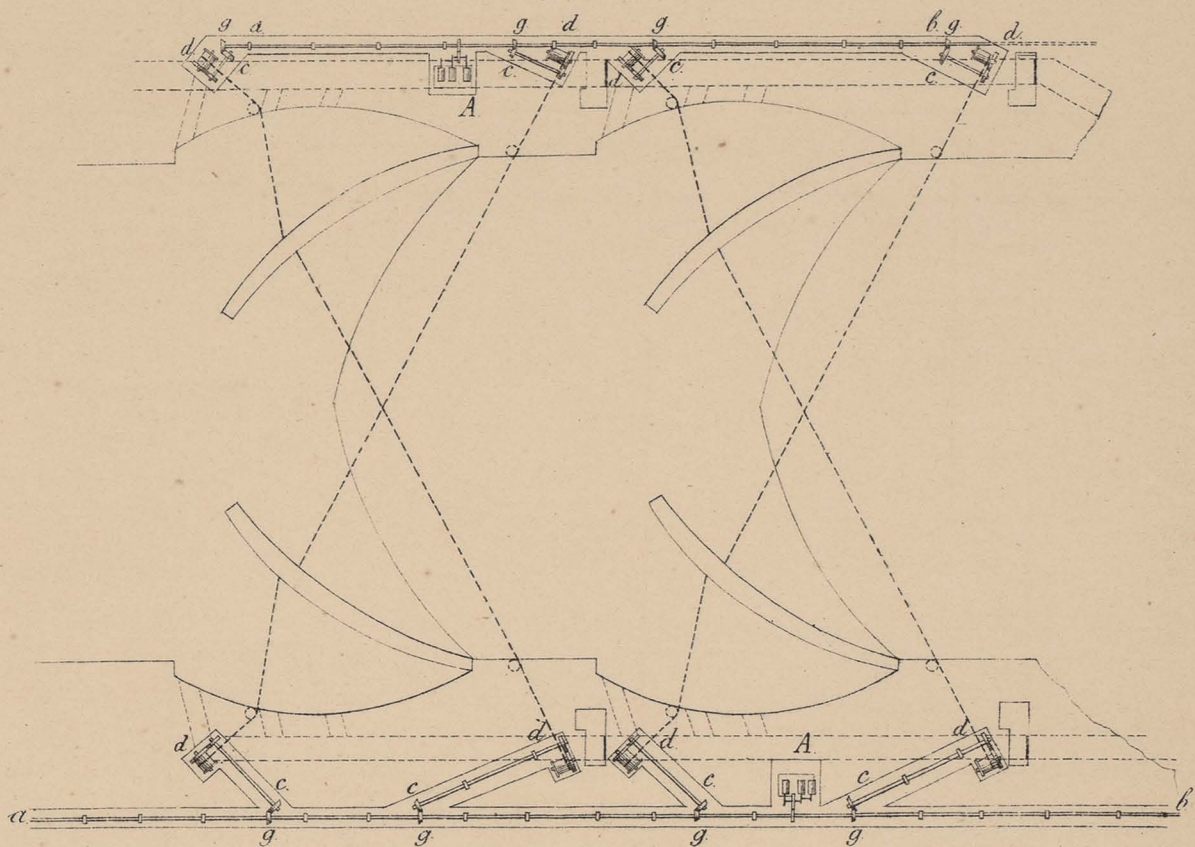

Фиг. 107.

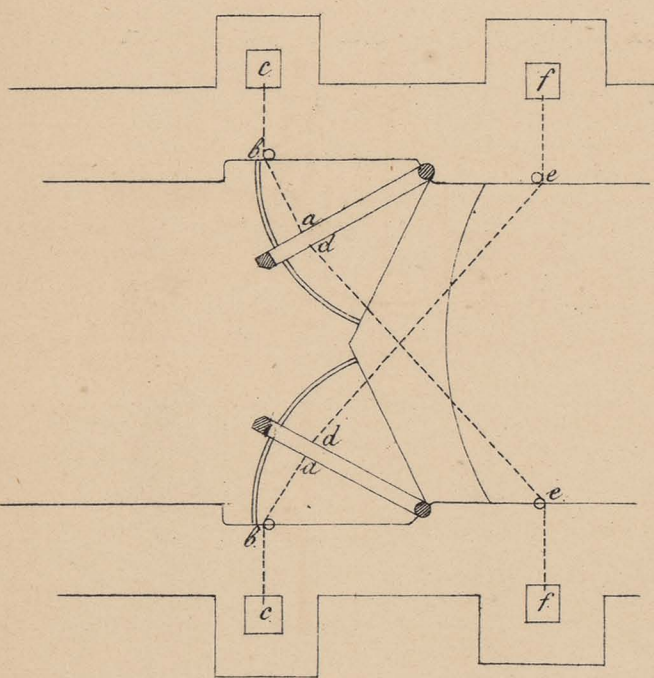

Фиг. 110.

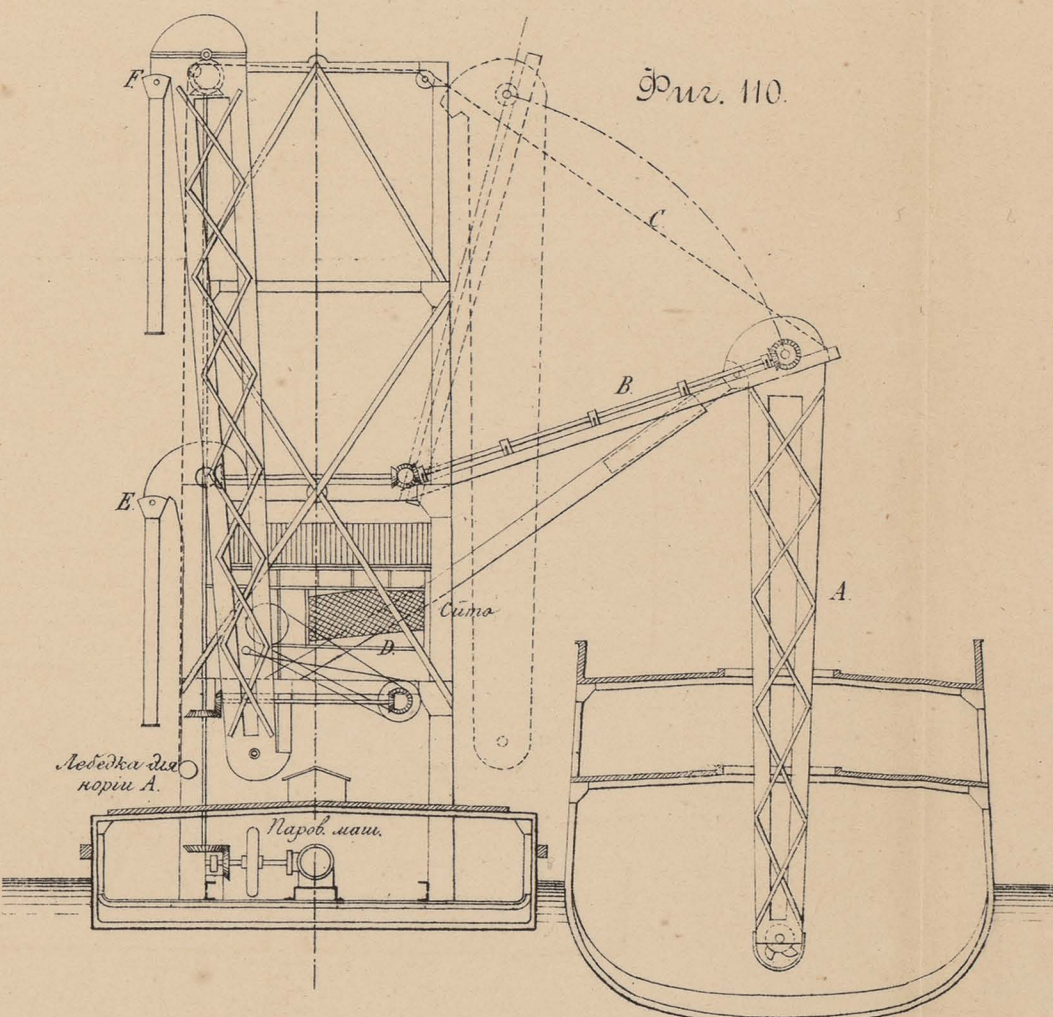

Фиг. 111.

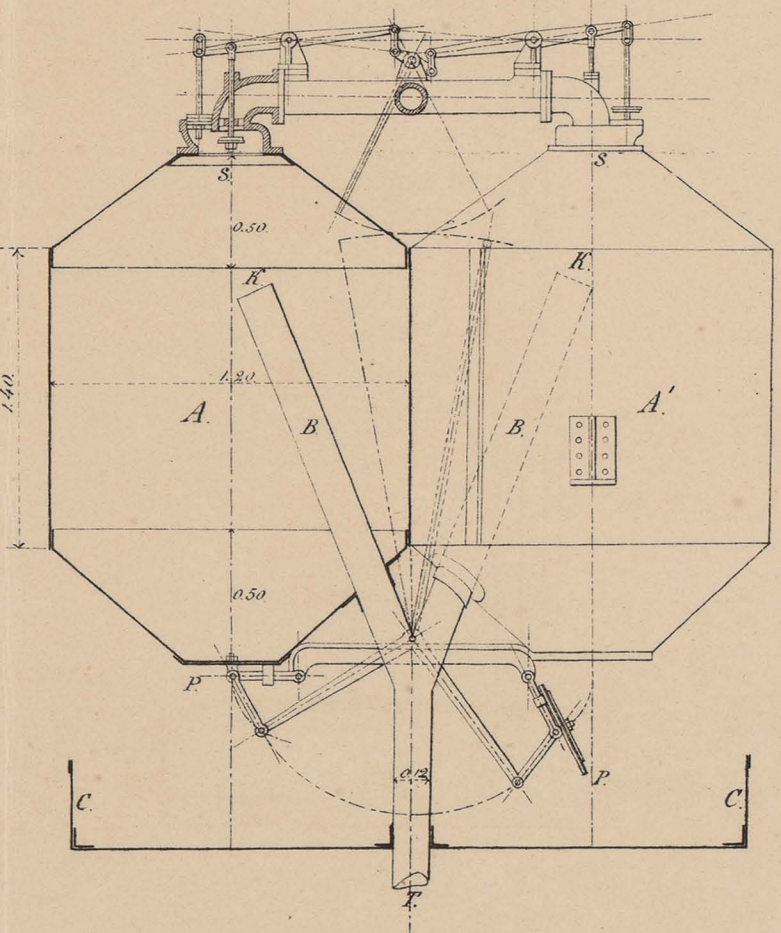

Фиг. 112.

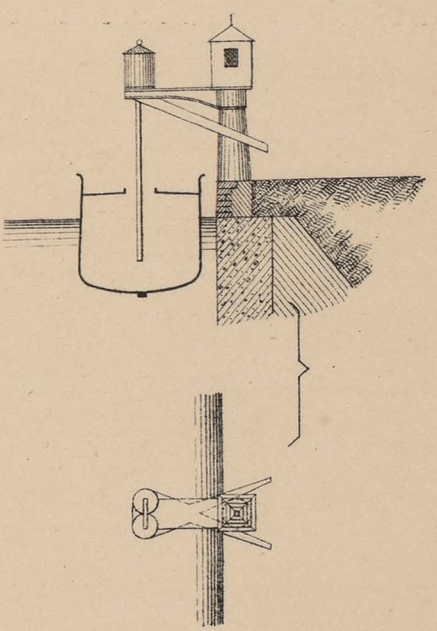







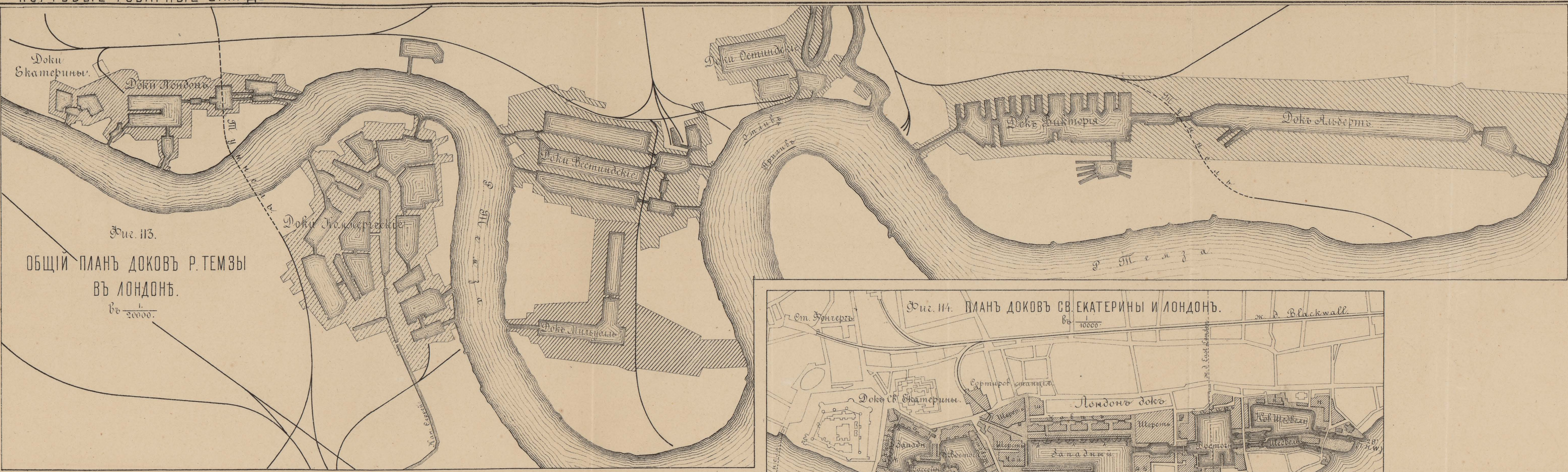
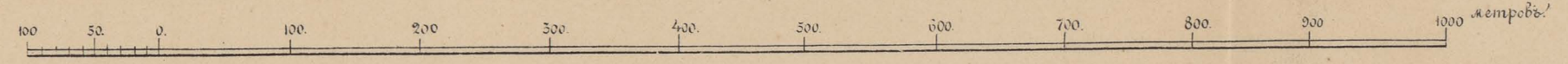

Fig. 113.  
ОБЩИЙ ПЛАН ДОКОВЪ Р.ТЕМЗЫ  
ВЪ ЛОНДОНѢ.  
въ  $\frac{1}{20000}$ .

Масштабъ въ  $\frac{1}{20000}$  къ фиг. 113.



Масштабъ въ  $\frac{1}{10000}$  къ фиг. 114, 117, 120 и 123.

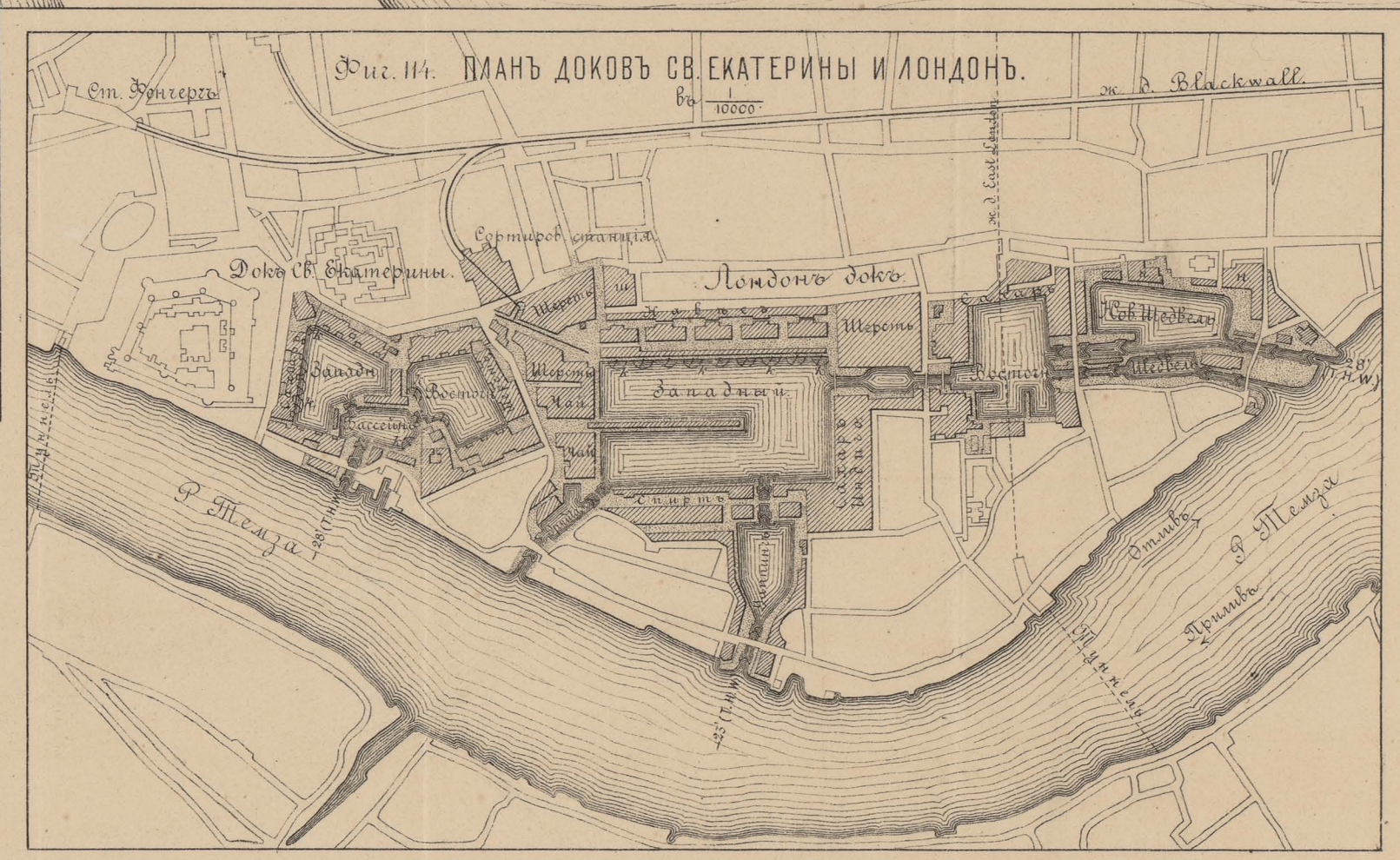
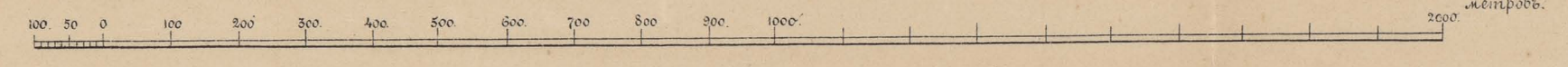

Fig. 114. ПЛАНЪ ДОКОВЪ СВ.ЕКАТЕРИНЫ И ЛОНДОНЪ.  
въ  $\frac{1}{10000}$ .

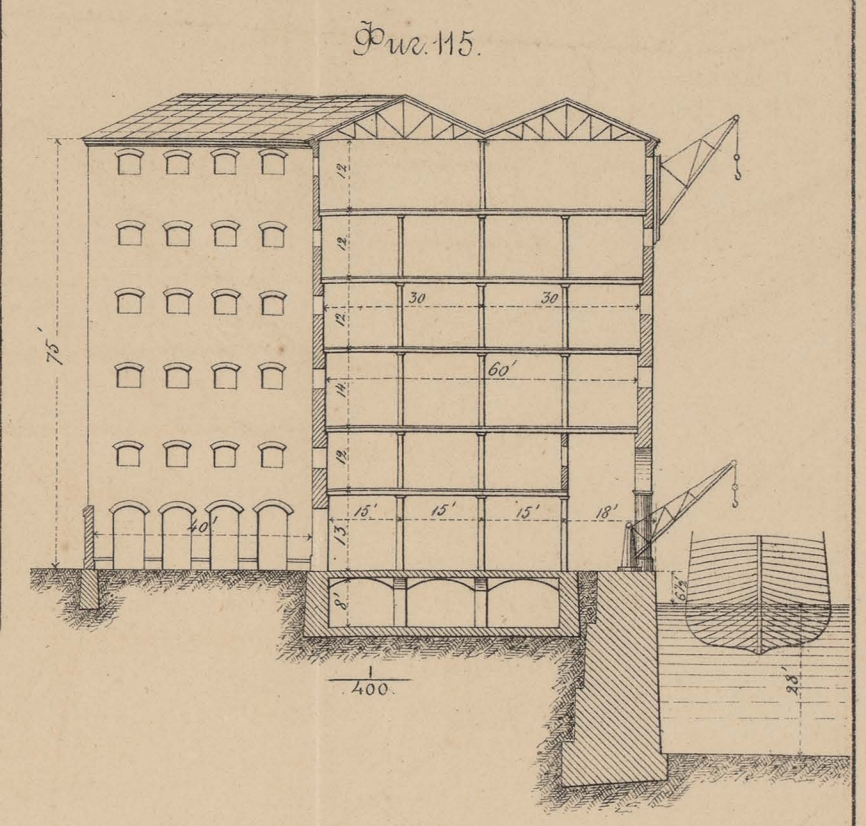

Fig. 115.

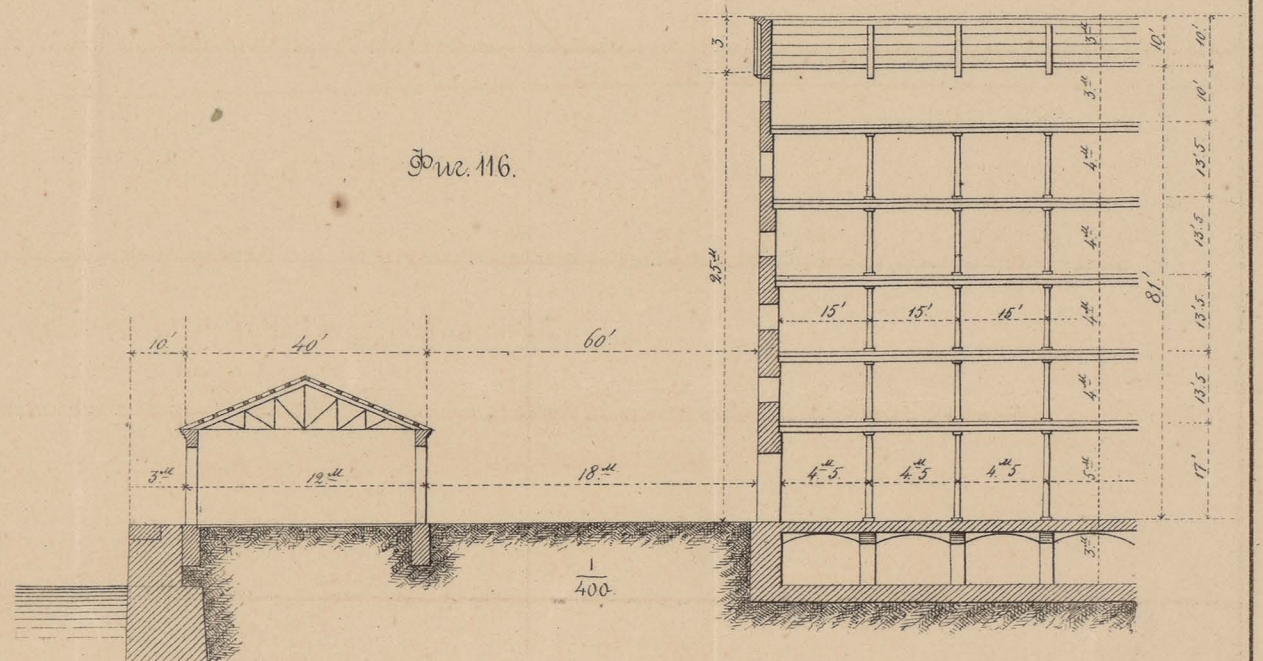

Fig. 116.

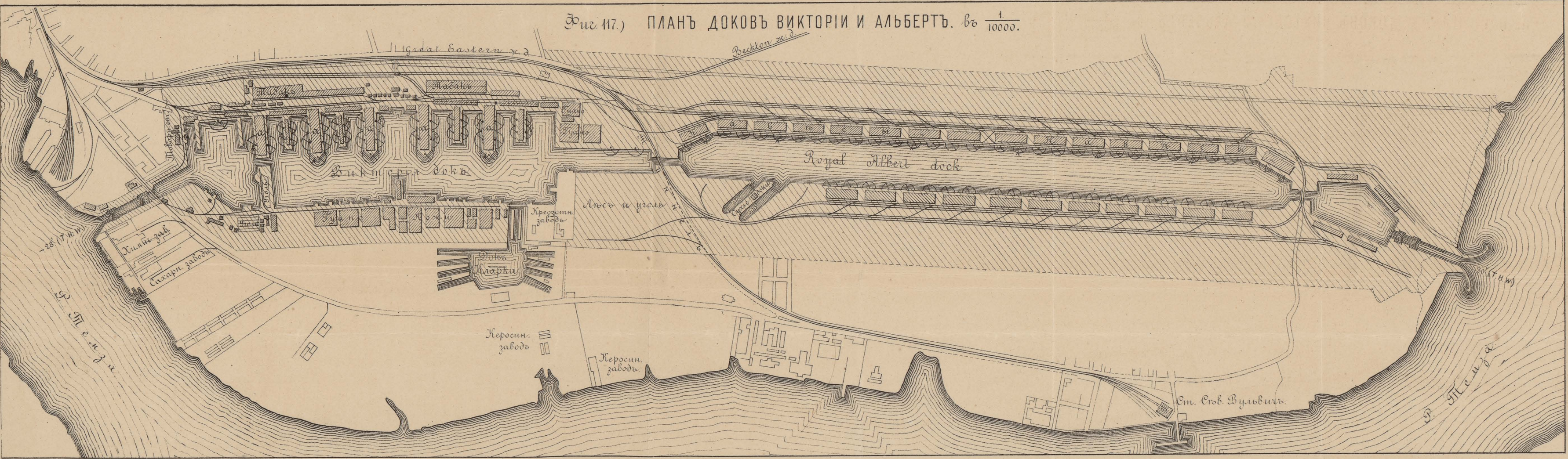

Fig. 117. ПЛАНЪ ДОКОВЪ ВИКТОРИИ И АЛЬБЕРТЪ. въ  $\frac{1}{10000}$ .

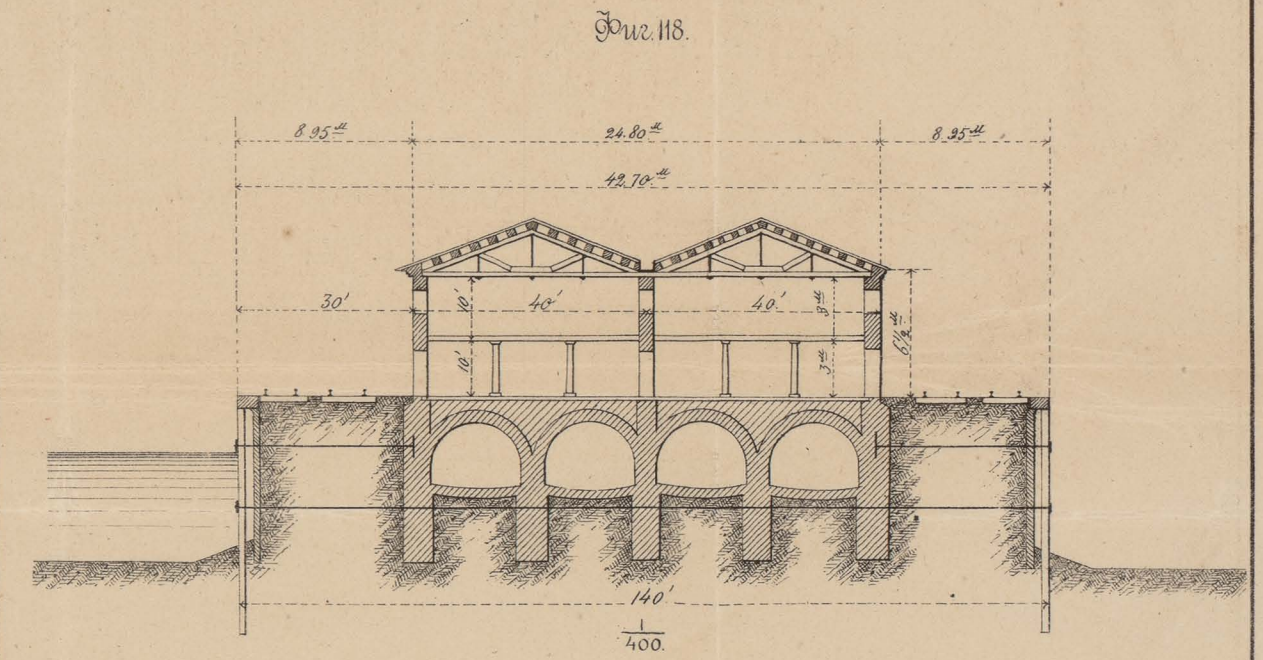

Fig. 118.

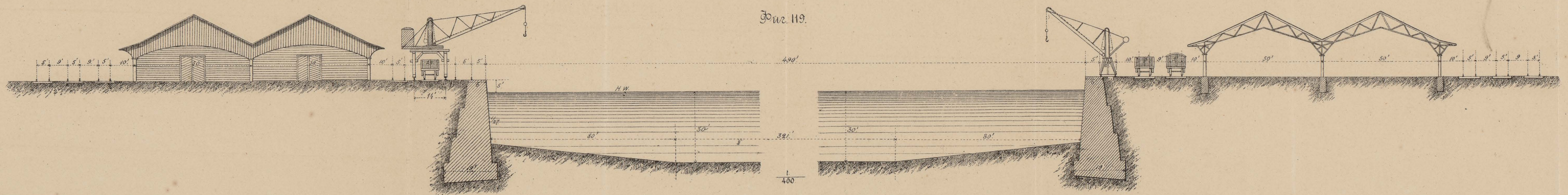

Fig. 119.













2011120820